

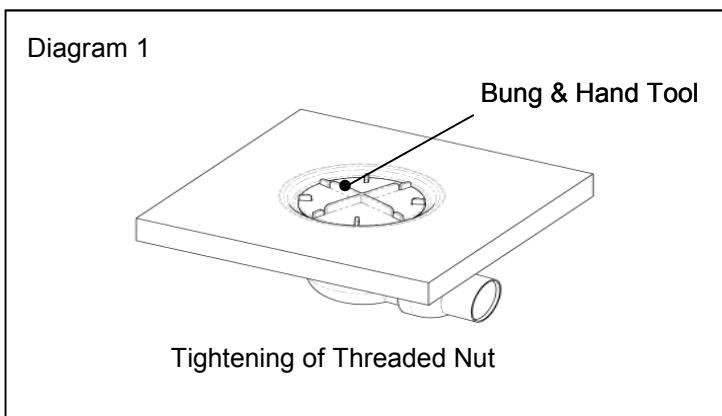

Installation and Maintenance Instructions for Easy clean Waste - 40mm outlet

1. Ensure the Plastic protective film has been removed from around the tray waste area
2. Apply a generous bead of a suitable Silicone sealant around the top rim of the waste hole of the shower tray
3. Ensure that the **Seal Ring** is correctly in place on the **Waste Trap Body** flange
4. Insert the **Threaded Nut** through the waste hole into the **Waste Trap Body** and tighten using the **Bung & Hand Tool** (See diagram No.1)
5. Clean up any excess sealant
6. Remove the **Bung & Hand Tool**
7. Install the **Intermediate Cup** ensuring the cup slides down into the grooves of the **Threaded Nut**
8. Complete the installation by inserting the **Cover and Inner Tube** assembly into the **Threaded Nut** and push lightly into place.
9. Align the **Cover** so the sides are sitting parallel to tray's recess

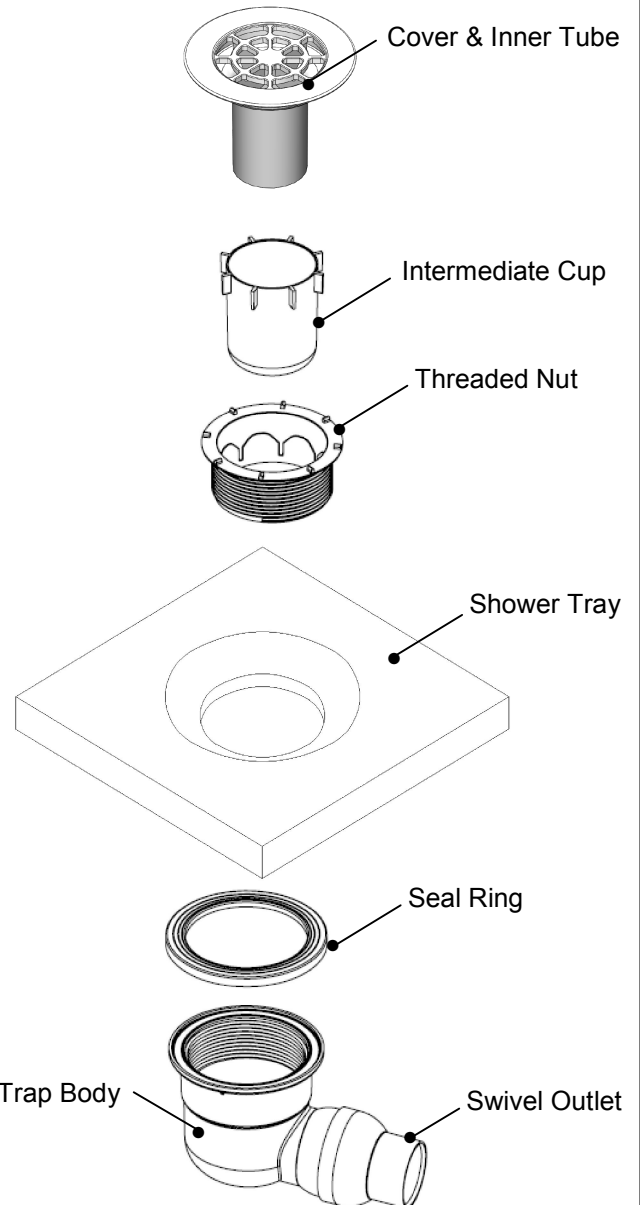

IMPORTANT INSTALLATION NOTES

- Installation of the Easy clean waste be undertaken by a registered Plumber
- The installation must comply with all Council and Local Authority requirements
- It is the responsibility of the person who installs the Shower Waste to ensure that the installation is watertight and that the outlet pipe has a minimum fall of 1.5 degrees
- No other waste fitting must be fitted downstream of the Easy clean waste, this will considerably reduce the flow rate
- The Swivel outlet must not be installed under any undue pressure from the connecting pipe work

Maintenance and Cleaning of the Easy clean Waste

- Use only soap and water detergents to clean when required. **Do not** use organic solvents or abrasive cleaners
- Lift out the Waste Cover/Inner tube assembly
- Remove the Intermediate Cup from the waste and clean/remove any dirt, hair, sand or other debris. Wipe the cup clean
- Replace the Intermediate Cup
- Replace the Cover assembly

