



2016/2017 RANGE





## 100% NEW ZEALAND OWNED AND OPERATED

Established in 1946, Clearlite is a trusted supplier of quality bathroomware designed with New Zealand homes in mind. With over 40 years experience in the bathroom industry, our aim at Clearlite is to provide a selection of Showers, Vanities, Mirrors, Bathroom Furniture, Baths and Spas to suit the style needs and budgets of all New Zealanders.

We are a 100% New Zealand owned and operated company who believe in manufacturing quality products using trusted raw materials. This helps to ensure our products not only look good but stand the test of time. The majority of our product range is designed and manufactured here in New Zealand. We do import a selection of products some of which we design ourselves to complement our core range. All products are subject to our own quality control check before dispatch.



## CLEARLITE.CO.NZ

We recommend you visit the Clearlite website to help with the planning of your new home or bathroom renovation project. Our website is packed with helpful information from printable technical drawings and installation instructions to product images which are all on hand to assist with your bathroom product selection. You are also able to view our full list of independent Shower Installers in your area who can correctly install your shower.

## WHERE TO ORDER

For product queries and ordering, please visit your local plumbing or building merchant. See [www.clearlite.co.nz/retailers/](http://www.clearlite.co.nz/retailers/) for merchant details.

## RECOMMENDED RETAIL PRICES

You can find recommended retail prices for all Clearlite products on our website. It's as easy as point and click to download a copy of the latest prices.

**clearlite.co.nz**

## SUPPORTING NEW ZEALAND FAMILIES

Ronald McDonald House is a home away from home for New Zealand families with children who are undergoing treatment at the Auckland Starship hospital. As a Ronald McDonald House Business Club Partner, Clearlite is able to give back to the community by supporting New Zealand families.

**rmhauckland.org.nz**



**RONALD McDONALD HOUSE®**  
AUCKLAND BUSINESS CLUB  
Proud member





## SHOWERS

Sierra.....	6-7
Cezanne .....	8-9
Millennium .....	10-11
Trombone Door .....	12
Glass Shelf.....	13
Diamond Fusion .....	13

## BATHS AND SPA BATHS

Pacific .....	18
Matisse .....	19
Varo .....	20
Gauguin.....	21
Kahlo .....	22
Raphael.....	23
Monet.....	24
Corniche .....	25
Renoir .....	25
Bianca .....	26
Riviera .....	26
Solar Shub.....	27
Dina Shub .....	27
Shower over Bath .....	28-29

## VANITIES

Statesman Classic .....	32
Statesman Drawer.....	33
Cashmere Classic.....	34
Cashmere Drawer.....	35
Cashmere Slim Classic .....	36
Cashmere Slim Drawer .....	37
Pinnacle .....	38
Pinnacle Slim.....	39
Raglan Classic .....	40
Raglan Drawer .....	41
Sumner.....	42
Grafton .....	43
Mirrors .....	44
Mahia Cabinet .....	44
Towers.....	45
Hand Basins .....	46-47
Cabinet Finishes and Details.....	48-49

DESIGN PARTNERS.....	48
----------------------	----

WARRANTIES.....	49
-----------------	----

BATHROOM PLANNER .....	50
------------------------	----



# SHOWERS

Clearlite showers are available in a selection of styles, sizes and configurations to suit any New Zealand bathroom. Our showers are constructed from the highest quality materials and are designed to enhance product longevity. All Clearlite shower enclosures come complete with tray, wall lining, door set, easy clean waste and installation pack.

Clearlite acrylic shower trays, wall liners and door sets\* are proudly manufactured in New Zealand. \*excluding our imported Cezanne sliding door set



## SAFETY GLASS

Bathroom projects may need to obtain a code of compliance. All Clearlite Showers are manufactured with this in mind and use toughened safety glass complying to AS/NZS2208.

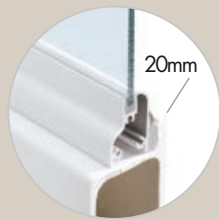

## SURE SEAL™ TRAY

The unique design of the Sure Seal™ Tray offers a full 20mm upstand around the perimeter of the shower. Both door and liner are installed within the tray so water flows back into tray whilst in use.

(Sierra 760mmx760mm tray is not Sure Seal)

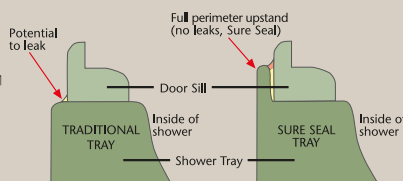

**LUCITE®**  
The source of inspiration



## ANTIBACTERIAL LINING

Senosan® premium quality sheets featuring Antibac are used in the manufacturing of Clearlite shower wall linings. The gloss material protects your family from bacteria with its easy-to-clean surface.

**senosan®**



## EASY CLEAN WASTE

All Clearlite showers include a chrome easy clean waste.



## CLEANING & MAINTENANCE

- Wipe down the shower or use a squeegee to remove excess water from the glass after use
- Use a trusted glass cleaner on shower glass and bath screens to remove soap deposits.
- Clean the shower tray and liner surfaces using the Vibrance Surface Cleaner or another cleaner that specifically states that it is suitable for use on acrylic surfaces
- Waste lid and cup should be removed and cleaned regularly
- Remove and clean drip seals on a regular basis









Sierra 1000x1000 Flat Wall Satin  
Statesman 900 Classic Floor Standing Manor Oak

## 2 SIDED

### 760 x 760

FLAT WALL	OS8F__7702
MOULDED WALL	OS8M__7702
TILED WALL	OS8T__7702

\* 760x760 is not sure seal and tray profile is 90mm instead of 70mm

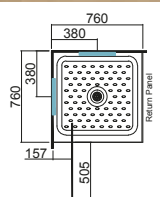

### 900 x 760 (900 door)

FLAT WALL	OS8F__9704
MOULDED WALL	OS8M__97041
TILED WALL	OS8T__9704

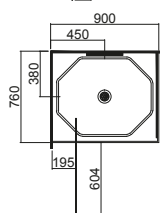

### 900 x 760 (760 door)

FLAT WALL	OS8F__9702
MOULDED WALL	OS8M__9702
TILED WALL	OS8T__9702

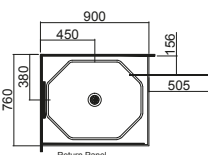

### 900 x 900

FLAT WALL	OS8F__9902
MOULDED WALL	OS8M__9902
TILED WALL	OS8T__9902

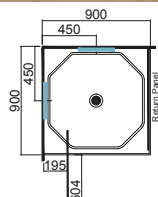

### 1000 x 1000

FLAT WALL	OS8F__1102
MOULDED WALL	OS8M__1102
TILED WALL	OS8T__1102

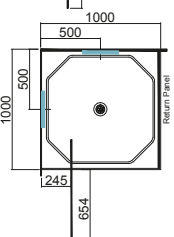

### 1200 x 900

FLAT WALL	OS8F__1202
MOULDED WALL	OS8M__1202
TILED WALL	OS8T__1202

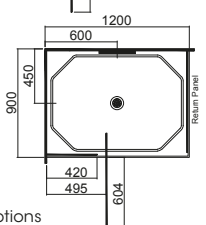

## 3 SIDED

### 760 x 760

FLAT WALL	OS8F__7701
MOULDED WALL	OS8M__7701
TILED WALL	OS8T__7701

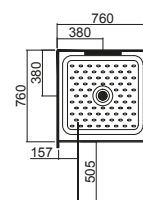

### 900 x 760 (900 Door)

FLAT WALL	OS8F__9703
MOULDED WALL	OS8M__9703
TILED WALL	OS8T__9703

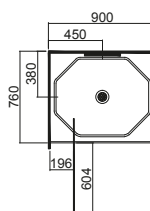

Only soap recess position available Shows alternative moulded soap recess position options

**WHEN ORDERING:** Complete your chosen product code above by specifying one of the below joinery codes in the blank space within the code \_\_

Use **00** for White; **03** for Satin

# SIERRA

- 70mm Sure Seal Shower Tray (see pg 4)
- Chrome Easy Clean Waste
- Flat or moulded one-piece Senosan® wall lining
- Suitable for tiled walls when wall receivers are installed to waterproofing prior to tiling
- Enclosure height 1870mm (nominal overall)
- White or Satin Joinery
- 6mm Safety glass door complying to AS/NZS 2208
- Door can be left or right hand opening
- Door can be positioned on either side of 2 Sided Square showers
- Full length aluminium handle incorporating magnetic door closure
- Chrome pivot covers
- Optional Diamond Fusion™ treatment available (see page 13)
- 5 Year warranty (12 month warranty on drip strips and vertical seals)

Made in New Zealand



Sierra 1000x1000 2 Sided Moulded Wall White

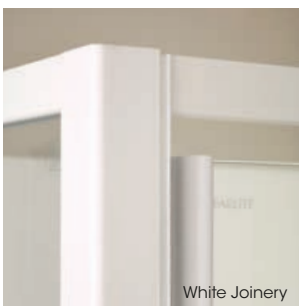

White Joinery



Satin Joinery



Optional Glass Shelves



Sierra 900x900 2 Sided Tile Wall Satin

## 900 x 760 (760 Door)

FLAT WALL	OS8F__9701
MOULDED WALL	OS8M__9701
TILED WALL	OS8T__9701

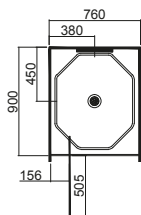

## 900 x 900

FLAT WALL	OS8F__9901
MOULDED WALL	OS8M__9901
TILED WALL	OS8T__9901

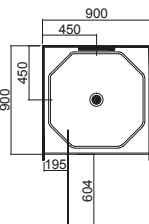

## 1000 x 1000

FLAT WALL	OS8F__1101
MOULDED WALL	OS8M__1101
TILED WALL	OS8T__1101

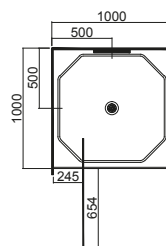

## 1200 x 900 (1200 Door)

FLAT WALL	OS8F__1201
MOULDED WALL	OS8M__1201
TILED WALL	OS8T__1201

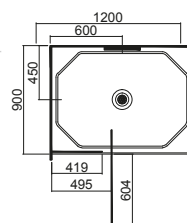

## ANGLE CORNER

### 900 x 900

FLAT WALL	OS8F__9903
MOULDED WALL	OS8M__9903
TILED WALL	OS8T__9903

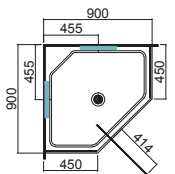

### 1000 x 1000

FLAT WALL	OS8F__1103
MOULDED WALL	OS8M__1103
TILED WALL	OS8T__1103

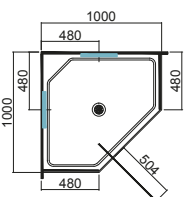

— Only soap recess position available — Shows alternative moulded soap recess position options

**WHEN ORDERING:** Complete your chosen product code above by specifying one of the below joinery codes in the blank space within the code \_\_  
Use **00** for White; **03** for Satin





# CEZANNE

- 70mm Sure Seal Shower Tray (see pg 4)
- Chrome Easy Clean Waste
- Flat or moulded one piece Senosan® wall lining
- Optional moulded wall features corner soap recess with foot rest
- Suitable for tiled walls when wall receivers are installed to waterproofing prior to tiling
- Enclosure height 1970mm (nominal overall)
- White or Bright Joinery
- 6mm safety glass door complying to AS/NZS2208
- Child proof safety locking feature to prevent accidental release of doors
- Contemporary square bar handles
- Magnetic door closure
- Space saving sliding doors
- Long return panels for increased internal showering space
- Minimal overlapping glass panels for trouble free cleaning
- Quick release double roller door system for easy cleaning
- 5 year warranty (12 month warranty on drip strips and vertical seals)



Cezanne 1000x1000 Moulded Wall Bright



White Joinery

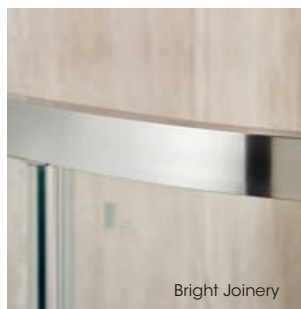

Bright Joinery



Optional Glass Shelves



Cezanne 900x900 Tiled Wall Bright

## 900 x 900

FLAT WALL	0C9F__9904
MOULDED WALL	0C9M__9904
TILED WALL	0C9T__9904

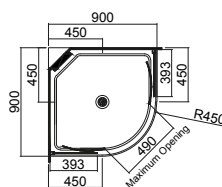

## 1000 x 1000

FLAT WALL	0C9F__1104
MOULDED WALL	0C9M__1104
TILED WALL	0C9T__1104

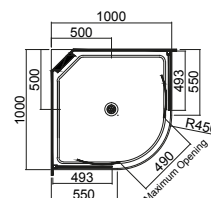

## 800 x 1200

FLAT WALL	0C9F__8204
MOULDED WALL	0C9M__8204
TILED WALL	0C9T__8204

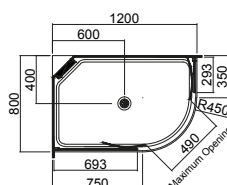

## 1200 x 800

FLAT WALL	0C9F__2804
MOULDED WALL	0C9M__2804
TILED WALL	0C9T__2804

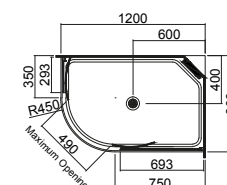

— Indicates optional moulded soap recess position

**WHEN ORDERING:** Complete your chosen product code above by specifying one of the below joinery codes in the blank space within the code \_\_  
Use **00** for White; **03** for Bright



Millennium 900x900 2 Sided Moulded Wall Satin  
Cashmere 900 Single Drawer Basalt

## 2 SIDED

### 900 x 900

FLAT WALL	0M9F__9902
MOULDED WALL	0M9M__9902
TILED WALL	0M9T__9902

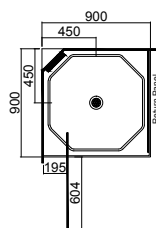

### 900 x 1200

FLAT WALL	0M9F__1202
MOULDED WALL	0M9M__12021
TILED WALL	0M9T__1202

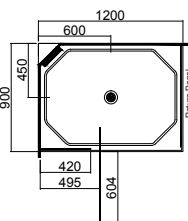

### 1000 x 1000

FLAT WALL	0M9F__1102
MOULDED WALL	0M9M__1102
TILED WALL	0M9T__1102

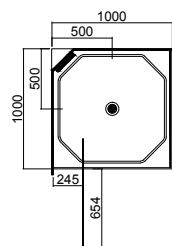

### 1200 x 900

FLAT WALL	0M9F__1202
MOULDED WALL	0M9M__1202
TILED WALL	0M9T__1202

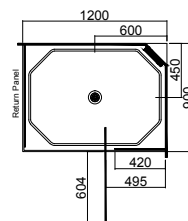

## 3 SIDED

### 900 x 900 (Left Hand Moulding)

FLAT WALL	0M9F__9901
MOULDED WALL	0M9M__9904
TILED WALL	0M9T__9901

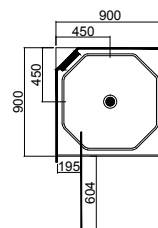

### 900 x 900 (Right Hand Moulding)

FLAT WALL	0M9F__9901
MOULDED WALL	0M9M__9905
TILED WALL	0M9T__9901

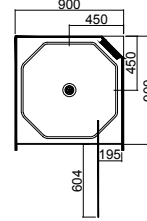

— Indicates optional moulded soap recess position

**WHEN ORDERING:** Complete your chosen product code above by specifying one of the below joinery codes in the blank space within the code \_\_

Use **00** for White; **03** for Satin



# MILLENNIUM

- 70mm Sure Seal Shower Tray (see pg 4)
- Chrome Easy Clean Waste
- Flat or moulded one piece Senosan® wall lining
- Optional moulded wall features corner soap recesses with foot rest
- Moulding can be in the left or right hand corner of 3 Sided showers
- Suitable for tiled walls when wall receivers are installed to waterproofing prior to tiling
- Enclosure height 1970mm (nominal overall)
- White or Satin Joinery
- 6mm Safety glass door complying to AS/NZS 2208
- Door left or right hand opening
- Door can be positioned on either side of 2 Sided Square showers
- Magnetic door closure
- Chrome pivot covers
- Contemporary handle
- Optional Diamond Fusion™ treatment available (see page 13)
- 5 Year warranty (12 month warranty on drip strips and vertical seals)

Made in New Zealand



Millennium 900x900 2 Sided Flat Wall White  
Cashmere 900 Drawer Open Basalt



White Joinery



Satin Joinery

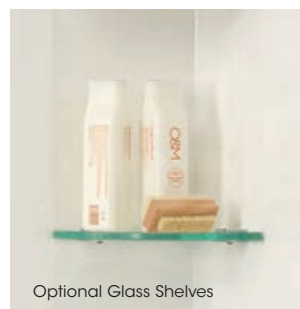

Optional Glass Shelves



Millennium 900x900  
2 Sided Tiled Wall Satin  
Cashmere Single Drawer Charred Oak

## 1000 x 1000 (Left Hand Moulding)

FLAT WALL	0M9F__1101
MOULDED WALL	0M9M__1104
TILED WALL	0M9T__1101

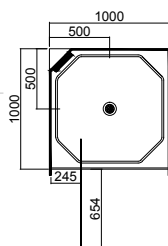

## 1000 x 1000 (Right Hand Moulding)

FLAT WALL	0M9F__1101
MOULDED WALL	0M9M__1105
TILED WALL	0M9T__1101

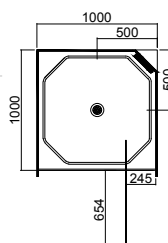

## 1200 x 900 (Left Hand Moulding)

FLAT WALL	0M9F__1201
MOULDED WALL	0M9M__1204
TILED WALL	0M9T__1201

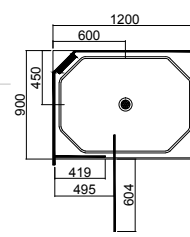

## 1200 x 900 (Right Hand Moulding)

FLAT WALL	0M9F__1201
MOULDED WALL	0M9M__1205
TILED WALL	0M9T__1201

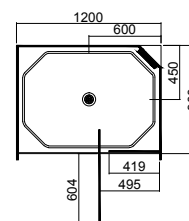

## ANGLE CORNER

### 900 x 900

FLAT WALL	0M9F__9903
MOULDED WALL	0M9M__9903
TILED WALL	0M9T__9903

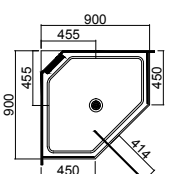

### 1000 x 1000

FLAT WALL	0M9F__1103
MOULDED WALL	0M9M__1103
TILED WALL	0M9T__1103

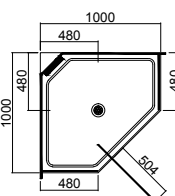

— Indicates optional moulded soap recess position

**WHEN ORDERING:** Complete your chosen product code above by specifying one of the below joinery codes in the blank space within the code \_\_  
Use **00** for White; **03** for Satin

## THE ULTIMATE FOR RENOVATIONS!

The Trombone is a fully adjustable door that can be easily customised to fit the size of the door opening required. Trombone doors are a great way to update your bathroom in a rental, bach or home. There are five door sizes to choose from between 640mm to 1000mm. The Trombone features a full length aluminium handle with integrated magnetic closure. Trombone doors are available in White.

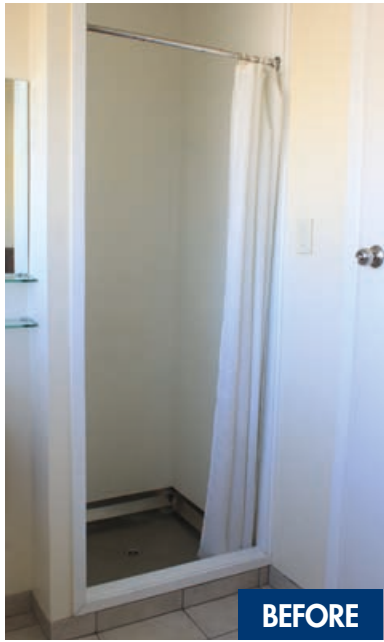

## HOW TO USE THE TROMBONE TAPE MEASURE

By using our tape measure you can easily select the right Trombone door for you. The Trombone tape is available at the Clearlite showroom or your local building/plumbing merchant

1. Extend the Trombone door tape measure across the area where the door will fit
2. Make sure the left end of the tape is flush against the left side of the door opening
3. Note which Colour-Zone on the right of the tape crosses the right side of the door opening
4. Repeat the process at the top and bottom of the door opening to check the Colour-Zone is the same in both areas
5. Go to your nearest Clearlite stockist and purchase the door that matches the Colour-Zone

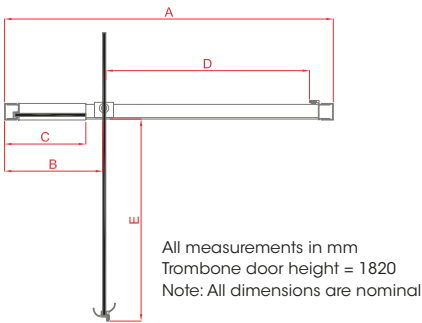

Size	Code	A (Minimum / Maximum)	B (Minimum / Maximum)	C	D	E
640 Red	100600640	640 / 700	188 / 248	140	399	396
700 Green	100600700	700 / 760	218 / 278	184	429	426
760 Yellow	100600760	760 / 840	218 / 298	184	489	486
840 Purple	100600840	840 / 940	268 / 368	220	519	516
940 Orange	100600940	940 / 1000	328 / 388	290	559	556

RED	640-700mm	GREEN	700-760mm	YELLOW	760-840mm	PURPLE	840-940mm	ORANGE	940-1000mm
-----	-----------	-------	-----------	--------	-----------	--------	-----------	--------	------------

# OPTIONAL EXTRAS

## GLASS SHELF

- Subtle storage solution
- 10mm toughened safety glass with slim chrome plated brackets
- Suitable for use with acrylic or tiled wall
- Can be retro fitted to existing walls

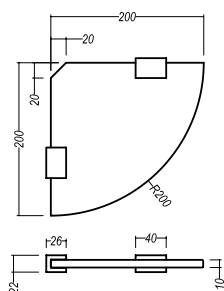

SHELF 7345040200



## DIAMOND FUSION<sup>TM</sup> easyCLEAN

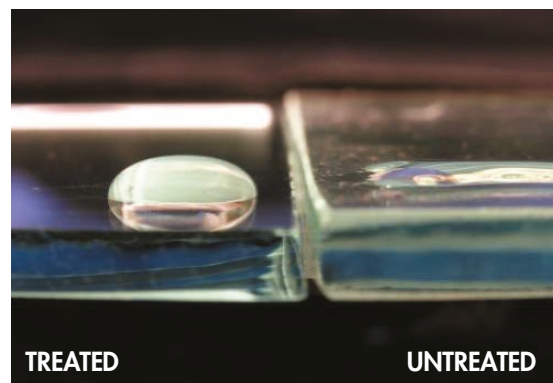

## LIFETIME WARRANTY

Diamond Fusion easyCLEAN offers an instant 1 year warranty. By a simple on-line registration customers can extend this to a LIFETIME WARRANTY, which is backed by a NZ wide agent network.

## WHAT IS DIAMOND FUSION?

Put simply, Diamond Fusion is a permanent treatment designed to seal and protect glass. Treated surfaces become water repellent as well as scratch, stain and impact resistant. Diamond Fusion easyCLEAN uses the world's leading Nano Technology products from "Diamond-Fusion International". Nanoscale technologies are the development and use of devices that have a size of only a few nanometres.

## HOW DOES IT WORK?

Glass is not as smooth as you might think – it is actually quite a porous surface which makes an ideal setting for soap residue, dirt and mineral build ups to reside which, over time can result in a cloudy or noticeably dull appearance. Diamond Fusion Easy Clean works in two stages to protect your glass from these impurities. The first stage "Fills in" the rough, porous surface of the glass and the second stage "Caps" the previous layer with an optically clear material which makes the surface significantly easier to clean and resistant to weathering.

## SAVE TIME NOW AND LATER

NOW - By opting for this optional treatment to be applied to your shower glass before it leaves the factory, there's no need to worry about arranging the application once your shower has been installed.

LATER - While you still need to maintain your glass, Diamond Fusion easyCLEAN takes the difficulty out of it. Your Saturday mornings will no longer be spent scrubbing your shower glass for hours.

XDFA DIAMOND FUSION SIZE A FOR 3 SIDED CLEARLITE SHOWERS  
XDFB DIAMOND FUSION SIZE B FOR 2 SIDED CLEARLITE SHOWERS AND SHOWER OVER BATHS

The Diamond Fusion easyCLEAN treatment is available on Sierra and Millennium showers as well as bath swing panels and door sets. Cezanne showers cannot be factory treated. Contact Diamond Fusion for post install price.





# BATHS & SPA BATHS

---

Clearlite offers an array of sizes and styles of baths to transform any bathroom into a relaxing sanctuary.

Clearlite's New Zealand made baths are made to our design and are manufactured using sanitary grade acrylic.







# CLEARLITE BATHS



Riviera 1700 Bath

Acrylic Bath	Size (l x w x d) External Dimensions	Internal Depth (Excludes upstands)	Bath Only	Framed Bath	Shower Over	Standard Spa	Whisper	Whisper + Mini	Hydro	Water Capacity* (L)
Pacific	1525 x 740 x 405mm	370	•	•	•	6 Jets	6 Jets			100
Pacific	1655 x 740 x 405mm	370	•	•	•	6 Jets	6 Jets			110
Matisse	1655 x 740 x 420mm	380	•	•	•	6 Jets	6 Jets			120
Varo	1675 x 750 x 470mm	460	•	•	•	6 Jets	6 Jets			145
Gauguin	1675 x 780 x 490mm	460	•	•	•	6 Jets	6 Jets	6 Whisper + 6 Mini Jets	6 Standard + 6 Mini Jets	109
Kahlo	1675 x 800 x 490mm	475	•	•	•	6 Jets	6 Jets	6 Whisper + 6 Mini Jets	6 Standard + 6 Mini Jets	135
Kahlo	1800 x 800 x 490mm	475	•	•	•	8 Jets	8 Jets	8 Whisper + 6 Mini Jets	8 Standard + 6 Mini Jets	170
Raphael	1675 x 750 x 500mm	475	•							200
Monet	1800 x 955 x 540mm	505	•	•		6 Jets	8 Jets	8 Whisper + 12 Mini Jets	6 Standard + 12 Mini Jets	140
Corniche	1300 x 1300 x 490mm	455	•	•		6 Jets				165
Renoir	1500 x 1500 x 555mm	520	•	•		7 Jets				180

Porcelain on steel Bath	Size (l x w x d) External Dimensions	Internal Depth (Excludes upstands)	Water Capacity (L)
Riviera	1400 x 700 x 385mm	380	125
Riviera	1500 x 700 x 385mm	380	140
Riviera	1600 x 700 x 385mm	380	155
Riviera	1700 x 700 x 385mm	380	170
Bianca	1700 x 750 x 398mm	390	180

Porcelain on steel baths are supplied with overflow and pop up waste

Acrylic Shubs	Size (l x w x d) External Dimensions	Internal Depth (Excludes upstands)	Water Capacity (L)
Dina	1200 x 820 x 440mm	420	125
Solar	910 x 910 x 345mm	325	115

All Dimension are nominal  
See page 17 for Spa Bath Info

\* Water capacities are the minimum operating water capacities for Standard Spas, 80mm from the top of the Raphael bath or to the overflow on Porcelain on Steel baths.



## BATH/SPA CLEANING AND MAINTENANCE

To keep your Bath or Spa Bath in top condition we recommend you clean it regularly with a soft cloth using a non-abrasive cleaner such as Vibrance Surface Cleaner. Make sure cleaners you use are recommended for use on acrylic surfaces so you don't cause damage to the surface. The Spa system should also be flushed on a regular basis. We recommend you use Vibrance Spa Flush every 3 months.



# SPA BATHS

Clearlite offers an array of sizes and styles of spa baths to transform any bathroom into a relaxing sanctuary.

## TYPES OF JETS

### STANDARD JETS

Standard Jets provide a concentrated flow of water and air through adjustable eyeball outlets that allow fingertip control of the directional flow and intensity of the water. Each jet can be independently adjusted to suit personal preferences. The pressure released by a Standard Jet delivers a deep massage that can relieve muscle tension and ease pain in targeted area.

### MINI JETS

Mini Jets are a quarter the size of a Standard Jet and are designed to deliver a flow of water and air through concentrated outlets. Positioned in clusters to focus on the lumbar region, the jet faceplate can be adjusted to vary water flow through the jet, delivering customised water intensity. This feature allows some or all of the Mini Jets to be turned up or down to suit individual needs.

### WHISPER JETS

Whisper Jets send air through the fixed jets, dispersing thousands of tiny air bubbles that produce a champagne effect in the water. On contact with the skin these bubbles create a relaxing and invigorating 'tingle' that helps sooth and relax the body. The pressure released creates a light soothing massage which is more gentle than a Standard Jet. *Whisper Jets are exclusive to Clearlite Bathrooms.*



## SPA OPTIONS

Combining different types of jets will optimise the function of the spa bath. We recommend selecting Mini Jets for a focused lumbar massage.



### STANDARD SPA

If a vigorous massage that targets specific areas to relieve body pain and sooth tender muscles is needed, then a **STANDARD SPA** would be the perfect choice.

### WHISPER

For general relaxation and to relieve stress, the **WHISPER SPA** is the ideal choice because it delivers a gentle tingling experience without a direct focus of pressure.

### WHISPER + MINI

The combination of **WHISPER + MINI JETS** provides the ultimate in relaxation, targeting the back area with the Mini Jets while delivering the soothing tingle created by Whisper Jets.

### HYDRO

A **HYDRO** Spa uses both Standard and Mini Jets for a high pressure water massage in all the key places. Standard Jets target the sides of the body and legs and the sets of Mini Jets deliver an invigorating focus on the back.

All Clearlite spa baths are made by a New Zealand team of specialists and are supplied with factory fitted plumbing, wooden support frame and heated pump.

### CONTROL PANEL

Clearlite spas feature a low voltage electronic touch pad to control the pump and heater. Unlike some other systems the Eco Heat button enables the heater to be turned off/on while the pump continues to operate.

### AIR BLEED

Clearlite Spa baths feature an air bleed function to introduce air into the water stream. When the air bleed is open, the jet is drawing maximum air creating a vigorous massage. When closed, only water comes through for a gentle soft massage.

### SAFETY SUCTION

The vortex suction system provides safety with a built-in bypass which neutralises the suction in the event of blockage.

**As our spa baths are made to order, it is important that you determine the positioning of the pump and control panel and ensure that you have access to these for general maintenance or servicing.**

# PACIFIC

- Bath, spa, or shower over bath options
- Contoured arm rests and lumbar support
- Anti slip tread pattern on base
- Features full perimeter moulded upstand
- Wooden support frame and bath skirts available
- Additional information, see page 16
- Spa bath features and options, see page 17
- Shower over bath options, see pages 28-29

Made in New Zealand



Pacific 1655 Bath Only

BATH ONLY	FRAMED BATH	SHOWER OVER	STANDARD SPA	WHISPER
-----------	-------------	-------------	--------------	---------

## 1525 BATH

0110000006

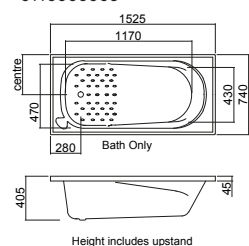

## 1525 FRAMED BATH

05900003

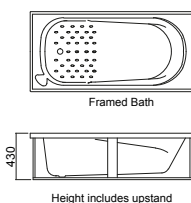

## 1525 STANDARD SPA

0509005016

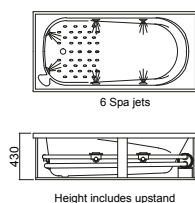

## 1525 WHISPER

0509003016

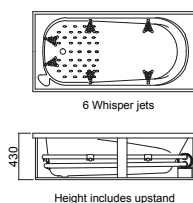

## 1655 BATH

0108000006

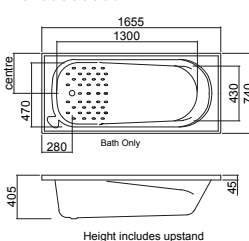

## 1655 FRAMED BATH

05900002

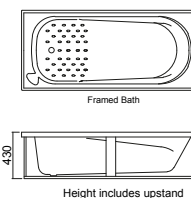

## 1655 STANDARD SPA

0506005016

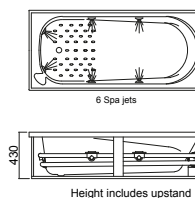

## 1655 WHISPER

0506003016

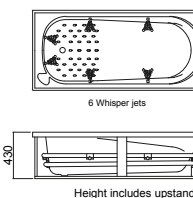

## SHOWER OVER 1525 STANDARD SWING PLATINUM SWING

2 WALL FLAT	0B10002F	0B61002F
2 WALL MOULDED	0B10002M	0B61002M
3 WALL FLAT	0B10003F	0B61003F
3 WALL MOULDED	0B10003M	0B61003M

## SHOWER OVER 1655 STANDARD SWING PLATINUM SWING

2 WALL FLAT	0B08002F	0B60002F
2 WALL MOULDED	0B08002M	0B60002M
3 WALL FLAT	0B08003F	0B60003F
3 WALL MOULDED	0B08003M	0B60003M



# MATISSE

- Bath, spa, or shower over bath options
- Contoured head rest, lumbar support and arm rests
- Features full perimeter moulded upstand
- Wooden support frame and bath skirts available
- Additional information, see page 16
- Spa bath features and options, see page 17
- Shower over bath options, see pages 28-29

Made in New Zealand



Matisse 1655 Bath Only

BATH ONLY

FRAMED BATH

SHOWER OVER

STANDARD SPA

WHISPER



Matisse Bath with Moulded Wall Liner and Standard Swing Panel

## BATH

0150000006

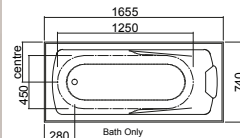

Bath Only

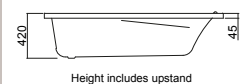

Height includes upstand

## FRAMED BATH

05900013

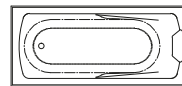

Framed Bath

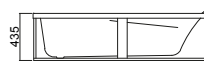

Height includes upstand

## STANDARD SPA

0511005016

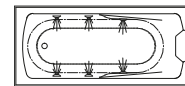

6 Spa jets

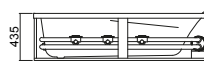

Height includes upstand

## WHISPER

0511003016

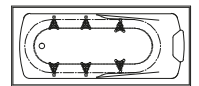

6 Whisper jets

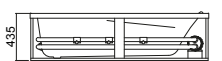

Height includes upstand



## SHOWER OVER

- 2 WALL FLAT
- 2 WALL MOULDED
- 3 WALL FLAT
- 3 WALL MOULDED

## STANDARD SWING

- 0B50002F
- 0B50002M
- 0B50003F
- 0B50003M

## PLATINUM SWING

- 0B67002F
- 0B67002M
- 0B67003F
- 0B67003M

- Bath, spa, or shower over bath options
- Elegant minimalist design
- Wooden support frame and bath skirts available
- Factory fitted upstands are recommended when bath is positioned against a wall
- Additional information, see page 16
- Spa bath features and options, see page 17
- Shower over bath options, see pages 28-29

Made in New Zealand



Varo 1675 Bath Only Island Set

	BATH	FRAMED BATH	STANDARD SPA	WHISPER
NO UPSTANDS	0154000006	05900016	0554002016	0554003016
WITH UPSTANDS	0154000006U	05900016U	0554002016U	0554003016U

<p>Height with optional upstand 485 mm</p>	<p>Height with optional upstand 525 mm</p>	<p>Height with optional upstand 525 mm</p>	<p>Height with optional upstand 525 mm</p>
--	--	--	--

Factory fitted upstands are recommended when bath is positioned against a wall



Varo 1675 with Platinum Swing Panel



# GAUGUIN

- Bath, spa, or shower over bath options
- Contoured lumbar support and arm rests
- Anti slip tread pattern on base
- Features full perimeter moulded upstand
- Wooden support frame and bath skirts available
- Additional information, see page 16
- Spa bath features and options, see page 17
- Shower over bath options, see pages 28-29

Made in New Zealand

Gauguin 1675 Bath Only Island Set

BATH ONLY

FRAMED  
BATH

SHOWER  
OVER

STANDARD  
SPA

WHISPER

WHISPER  
+ MINI

HYDRO

## 1675 BATH

0144000006

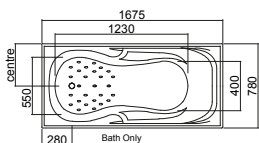

Height includes upstand

## 1675 FRAMED BATH

05900007

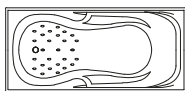

Framed Bath



Height includes upstand

## 1675 STANDARD SPA

0544005016

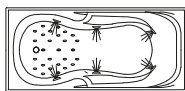

6 Spa jets

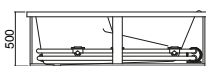

Height includes upstand

## 1675 WHISPER

0544003016

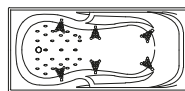

6 Whisper jets

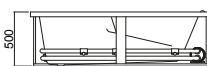

Height includes upstand

## 1675 WHISPER MINI

0544004016

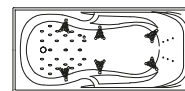

Whisper Jet / Mini Combination  
6 Whisper jets, 6 Mini jets

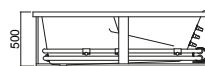

Height includes upstand

## 1675 HYDRO

0544006016

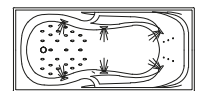

Hydrotherapy 6 Spa jets, 6 Mini jets

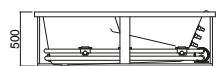

Height includes upstand

## SHOWER OVER

2 WALL FLAT

0B44002F

2 WALL MOULDED

0B44002M

3 WALL FLAT

0B44003F

3 WALL MOULDED

0B44003M

## STANDARD SWING

0B65002F

0B65002M

0B65003F

0B65003M

## PLATINUM SWING

0B65002F

0B65002M

0B65003F

0B65003M

- Bath, spa, or shower over bath options
- Contoured arm rests
- Wooden support frame and bath skirts available
- Factory fitted upstands are recommended when bath is positioned against a wall
- Additional information, see page 16
- Spa bath features and options, see page 17
- Shower over bath options, see pages 28-29

## Made in New Zealand



Factory fitted upstands are recommended when bath is positioned against a wall











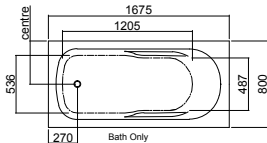
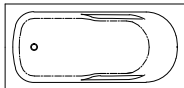
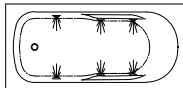
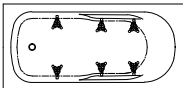
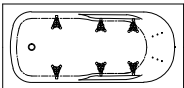
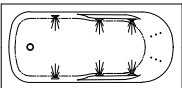

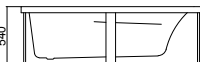
Kahlo 1800 2 Sided Moulded Wall AB Upstand Platinum Swing Panel

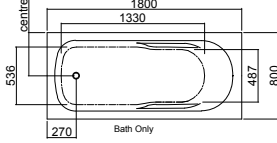
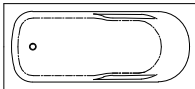
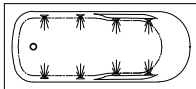
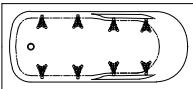
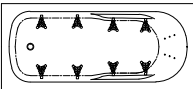
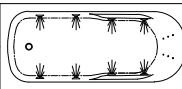

Kahlo 1800 Bath

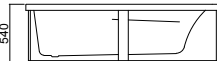
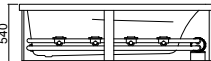
- BATH ONLY
- FRAMED BATH
- SHOWER OVER
- STANDARD SPA
- WHISPER
- WHISPER + MINI
- HYDRO

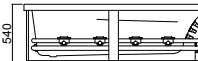
1675 BATH		1675 FRAMED BATH	1675 STANDARD SPA	1675 WHISPER	1675 WHISPER MINI	1675 HYDRO					
NO UPSTANDS	0151000006	05900014	0551002016	0551003016	0551004016	0551006016					
WITH UPSTANDS	0151000006U	05900014U	0551002016U	0551003016U	0551004016U	0551006016U					
	Bath Only		Framed Bath		6 Spa jets		6 Whisper jets		Whisper Jet / Mini Combination 6 Whisper jets, 6 Mini jets		Hydrotherapy 6 Spa jets, 6 Mini jets
	Height with optional upstand 505 mm		Height with optional upstand 555 mm		Height with optional upstand 555 mm		Height with optional upstand 555 mm		Height with optional upstand 555 mm		Height with optional upstand 555 mm
1800 BATH		1800 FRAMED BATH	1800 STANDARD SPA	1800 WHISPER	1800 WHISPER MINI	1800 HYDRO					
NO UPSTANDS	0152000006	05900015	0552005016	0552003016	0552004016	0552006016					
WITH UPSTANDS	0152000006U	05900015U	0552005016U	0552003016U	0552004016U	0552006016U					
	Bath Only		Framed Bath		8 Spa jets		8 Whisper jets		Whisper Jet / Mini Combination 8 Whisper jets, 6 Mini jets		Hydrotherapy 8 Spa jets, 6 Mini jets
	Height with optional upstand 505 mm		Height with optional upstand 555 mm		Height with optional upstand 555 mm		Height with optional upstand 555 mm		Height with optional upstand 555 mm		Height with optional upstand 555 mm

# RAPHAEL

- Bath only
- Contemporary deep oval bath with subtle contours along each side
- Island set / drop in bath designed to be positioned away from walls

Made in New Zealand



BATH ONLY



## BATH

0153000006

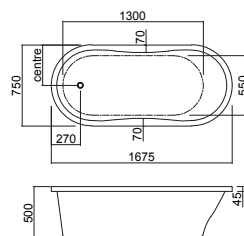



- Bath or spa options
- Deep two person bath with centre waste
- Contoured head rest, lumbar support and arm rests
- Wooden support frame and bath skirts available
- Additional information, see page 16
- Spa bath features and options, see page 17

Made in New Zealand

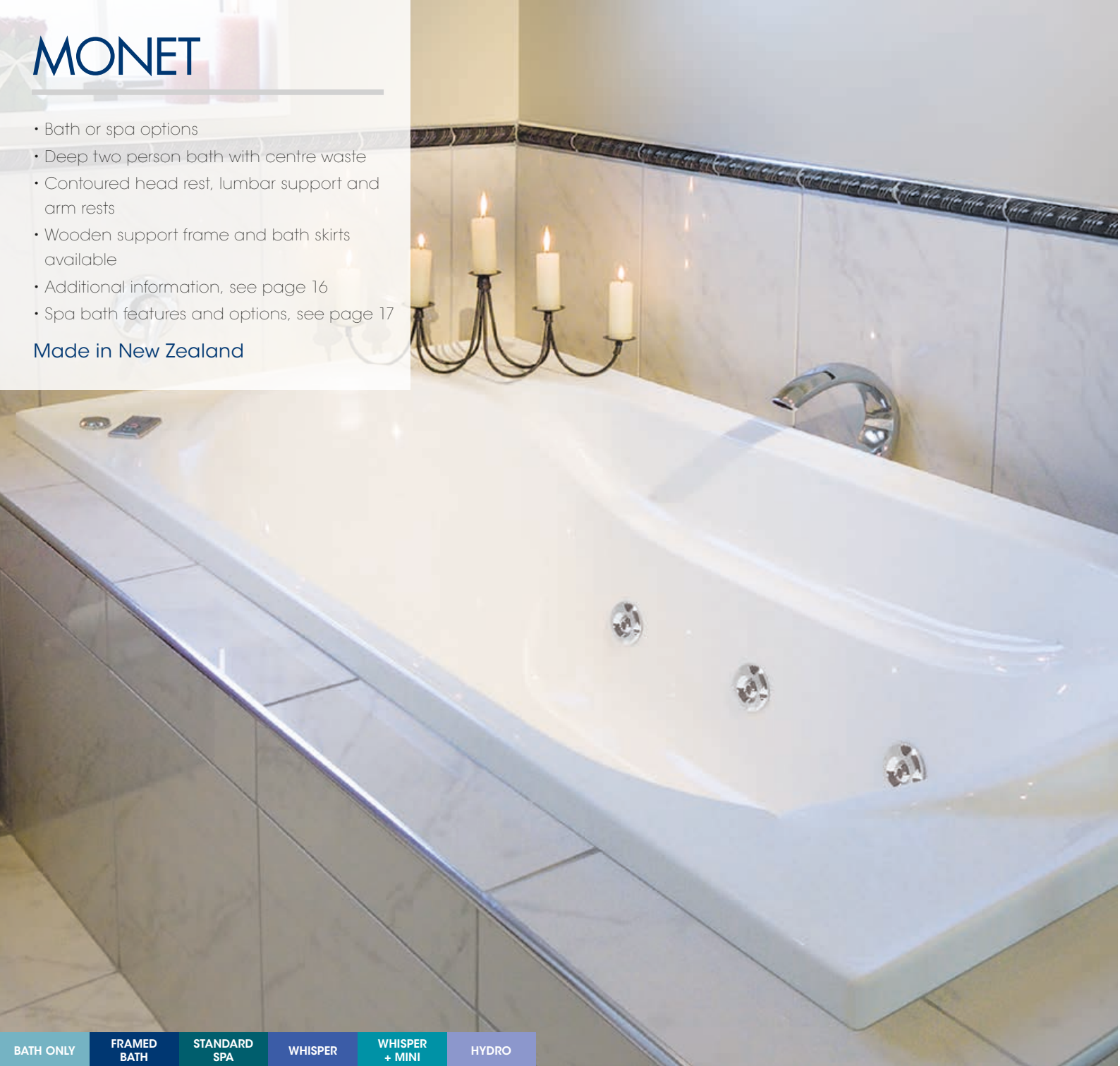

BATH ONLY

FRAMED  
BATH

STANDARD  
SPA

WHISPER

WHISPER  
+ MINI

HYDRO

## BATH

0143000006

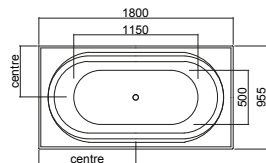

Height includes upstand

## FRAMED BATH

05900006

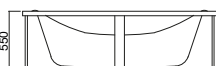
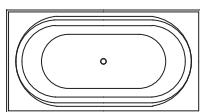

Height includes upstand

## STANDARD SPA

0543002016

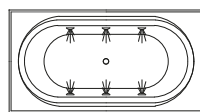

6 Spa jets

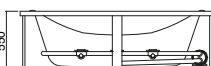

Height includes upstand

## WHISPER

0543003016

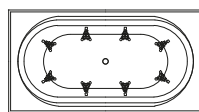

8 Whisper jets

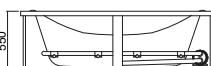

Height includes upstand

## WHISPER MINI

0543004016

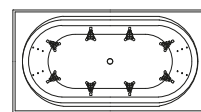

Whisper Jet / Mini Combination  
8 Whisper jets, 12 Mini jets

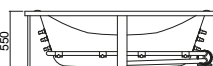

Height includes upstand

## HYDRO

0543006016

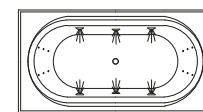

Hydrotherapy 6 Spa jets, 12 Mini jets

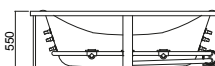

Height includes upstand





# CORNICHE

- Bath or spa options
- Contoured lumbar support
- Anti slip tread on base
- Wooden support frame and bath skirts available
- Additional information, see page 16
- Spa bath features and options, see page 17

Made in New Zealand

## BATH

0100000006

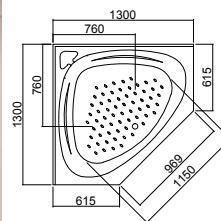

Height includes upstand

## FRAMED BATH

05900001

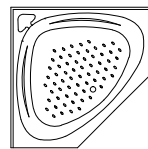

Height includes upstand

## STANDARD SPA

0500005016

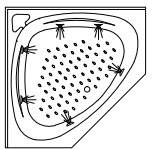

6 Spa jets

Height includes upstand



# RENOIR

- Bath or spa options
- Contoured lumbar support and arm rests
- Two person corner bath
- Wooden support frame and bath skirts available
- Additional information, see page 16
- Spa bath features and options, see page 17

Made in New Zealand

## BATH

0126000006

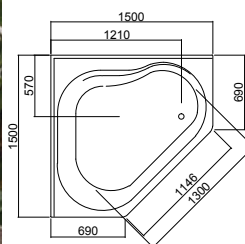

Height includes upstand

## FRAMED BATH

05900005

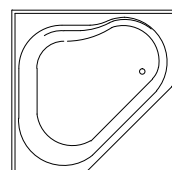

Height includes upstand

## STANDARD SPA

0526005016

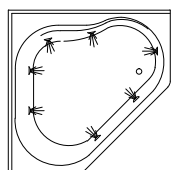

7 Spa jets

Height includes upstand

# BIANCA

- Porcelain on steel\*
- Includes overflow and pop up waste
- Arm rest for comfort
- Twin chrome hand grips
- 1.2mm steel
- Island set / drop in bath designed to be positioned away from walls
- Only available as bath option
- Not recommended for shower over bath

Made in Italy

1700

60BI0017

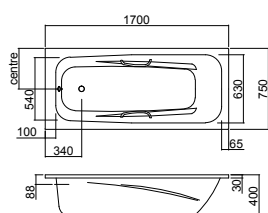

BATH ONLY



Chrome Hand Grip



Overflow and Pop Up Waste Rotary Knob

# RIVIERA

- Porcelain on steel\*
- Includes overflow and pop up waste
- 1.2mm steel
- Island set / drop in bath designed to be positioned away from walls
- Only available as bath option
- Not recommended for shower over bath

Made in Italy

1400

1500

1600

1700

60RI0014

60RI0015

60RI0016

60RI0017

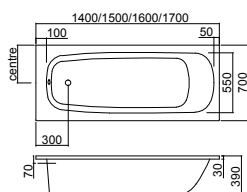

BATH ONLY

\* Due to the nature of its production, visible imperfections are part of the overall look of porcelain on steel baths



## SHUBS

Clearlite Dina and Solar shubs are designed for use in a shower over bath situation. With smaller size and easy access, shubs are especially ideal for children.

Dina 820x1200 2 Sided Moulded Wall

BATH ONLY

SHOWER  
OVER



## SOLAR

- Compact square bath
- 1820mm wall liner and doorset available for compact enclosure
- Door can be left or right hand opening

Made in New Zealand

**910 x 910**  
SHUB ONLY 0115000006

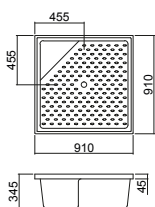

Height includes upstand

**SHOWER OVER 2 SIDED**  
**910 x 910**

**FLAT WALL** OB15002F  
**MOULDED WALL** OB15002M

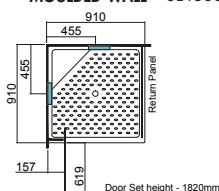

Door Set height - 1820mm

**SHOWER OVER 3 SIDED**  
**910 x 910**

**FLAT WALL** OB15003F  
**MOULDED WALL** OB15003M

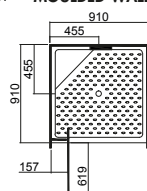

Shows moulded soap recess position options.  
Only moulded soap recess position available.

BATH ONLY

SHOWER  
OVER



## DINA

- Compact rectangular bath
- 1505mm wall liner and doorset available for compact enclosure
- Door can be left or right hand opening

Made in New Zealand

**1200 x 820**  
SHUB ONLY 0120000006

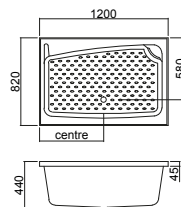

**SHOWER OVER 2 SIDED**  
**1200 x 820**

**FLAT WALL** OB20002F  
**MOULDED WALL** OB20002M

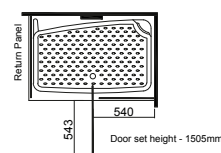

Door set height - 1505mm

**SHOWER OVER 3 SIDED**  
**1200 x 820**

**FLAT WALL** OB20003F  
**MOULDED WALL** OB20003M

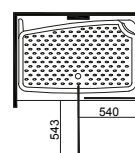

Only moulded soap recess position available.



# SHOWER OVER BATH

A shower over bath package is an ideal option to achieve maximum functionality by effectively utilising available space.

Clearlite baths listed below are also offered as a shower over bath package consisting of a bath, wall liner and swing panel - all parts are also available separately.

## SHOWER OVER

- Pacific
- Matisse
- Varo
- Gauguin
- Kahlo

Pacific and Matisse baths are also available as a shower enclosure with a complete door set. See page 29.



Kahlo Shower Over Bath, Platinum Swing Panel

## STANDARD SWING PANEL

- 900 x 1500 pivoting swing panel
- 6mm clear safety glass complies to AS/NZS 2208
- Panel swings inside and outside of bath
- Drip seal fitted to bottom of glass to deflect splashes
- White finish

Made in New Zealand

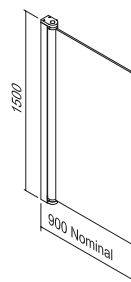

Standard Swing Panel

### STANDARD SWING PANEL

- |          |  |
|----------|--|
| 10090090 | SWING PANEL 900 FOR BATH WITH FULL PERIMETER UPSTAND |
| 10090095 | SWING PANEL 900 FOR BATH WITHOUT FRONT UPSTAND       |

## PLATINUM SWING PANEL

- 1100 x 1500 hinged swing panel
- 6mm clear safety glass complies to AS/NZS 2208
- Chrome hinges
- Support bracket provides a handy shelf
- Panel swings inside and outside of bath
- Fixed panel allows clearance when positioned next to a standard size vanity
- Drip seal fitted between glass and edge of bath to deflect splashes
- Satin finish

Made in New Zealand

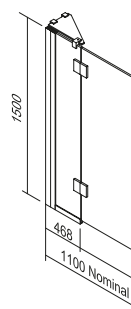

Platinum Swing Panel

### PLATINUM SWING PANEL

- |          |  |
|----------|--|
| 09800360 | PLATINUM SWING PANEL 1100 FOR BATH WITH FULL PERIMETER UPSTAND |
| 09800365 | PLATINUM SWING PANEL 1100 FOR BATH WITHOUT FRONT UPSTAND       |





Matisse Bath 2 Sided Flat Wall and Complete Door set

## COMPLETE DOOR SET

- Available to suit Pacific and Matisse Baths
- Door features 6mm clear safety glass complying to AS/NZS 2208
- Full length aluminium handle incorporating magnetic closure
- White finish
- Door can be left or right hand opening

Made in New Zealand

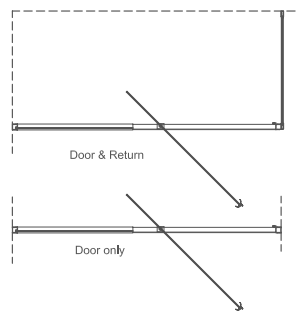

Please refer to website for full dimensions



## BATH WALL LINER

- Flat or moulded one piece Senosan® acrylic wall lining\*
- 2 and 3 sided options available
- 1530 high
- Custom size liners also available

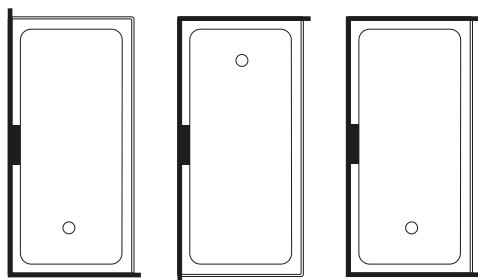

■ Indicates standard moulded soap recess position (centre)  
\*Kahlo baths not available with moulded 3 sided liner



Pacific 1655 2 Sided, Flat Wall 900 Standard Swing Panel

## OPTIONAL EXTRAS

Wooden support frame available for hassle free installation. Can be supplied on its own or factory fitted to bath.

Acrylic bath skirt available as a simple solution for finishing bath surround. Skirts available in 1 and 2 sided, or 3 sided for corner baths.

Glass Shelves available for subtle storage solution. See page 13 for details.

Diamond Fusion glass treatment available for swing panels. See page 13 for details.



DIAMOND FUSION®  
**easyCLEAN**

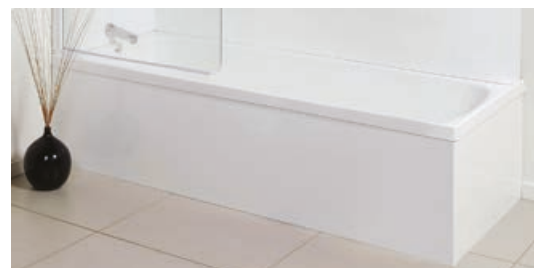



# VANITIES

---

Clearlite offers an array of vanity styles and sizes to transform any bathroom area into a functional and stylish space.

Our cabinets are manufactured in New Zealand from locally sourced board and are made and assembled by an expert team in New Zealand.





# STATESMAN

## CLASSIC

- Acrylic top with upstand
- Single tap hole only
- Classic doors and drawers and NEW open cabinet style
- Floor Standing and Wall Hung options
- Corner Vanity option (Floor Standing only)
- Soft closing doors and drawers
- Available in all cabinet finishes
- See pages 48-49 for additional information
- See pages 44-45 for mirrors and towers

Cabinets made in New Zealand



Statesman 1200 Classic Floor Standing Manor Oak



Statesman 750 Classic Wall Hung White Gloss



Statesman 900 Classic Floor Standing White Gloss

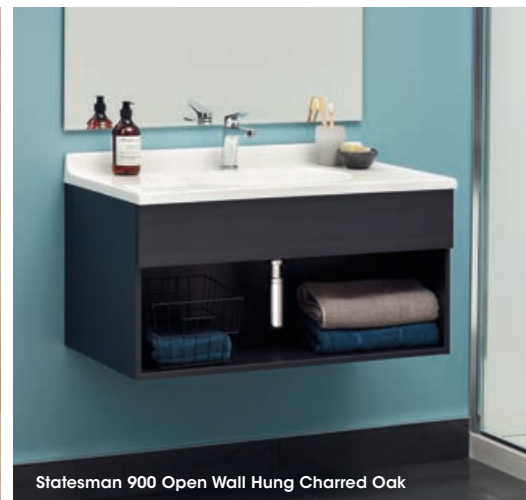

Statesman 900 Open Wall Hung Charred Oak

Refer to [clearlite.co.nz](http://clearlite.co.nz) for full specifications

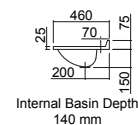
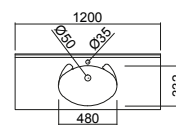
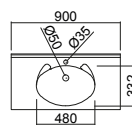
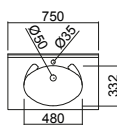
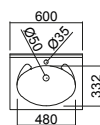
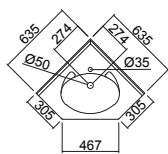

Internal Basin Depth  
140 mm

### OPEN

PRODUCT CODE

**600** **NEW**

4STA060O\_

**750** **NEW**

4STA075O\_

**900** **NEW**

4STA090O\_

**1200** **NEW**

4STA120O\_

Wall Hung

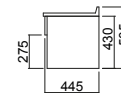
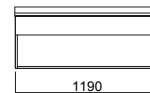
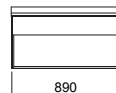

### DOORS & DRAWERS

PRODUCT CODE

**635**

4STA6X6C\_

**600**

4STA060C\_

**750**

4STA075C\_

**900**

4STA090C\_

**1200**

4STA120C\_

Wall Hung

N/A



Floor Standing

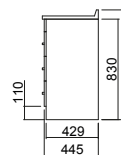
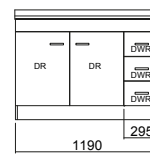
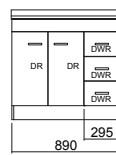
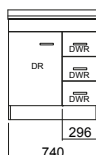
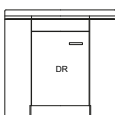

Drawer capacity rated to 9kg maximum load per drawer

**WHEN ORDERING:** Complete your chosen product code above by specifying one of the below cabinet finishes in the blank space at the end of the code \_  
Use **M** for White Melamine; **G** for White Gloss; **C** for Colour

# STATESMAN

## DRAWER

- Acrylic top with upstand
- Single tap hole only
- Contemporary drawer only and NEW drawer open cabinet style
- Floor Standing and Wall Hung options
- Soft closing drawers
- Available in all cabinet finishes
- See pages 48-49 for additional information
- See pages 44-45 for mirrors and towers

Cabinets made in New Zealand

Statesman 900 Single Drawer Open Wall Hung Basalt

Statesman 600 Single Drawer Dark Oak

Statesman 900 Double Drawer Wall Hung Carbon

Statesman 750 Double Drawer Floor Standing White Melamine

White Melamine

White Gloss

Dark Oak

Charred Oak

Silva Strata

Basalt

Nordic Ash

Manor Oak

Carbon

Refer to clearlite.co.nz for full specifications  
See left hand page for vanity top details

See page 48 for larger colour swatches

### SINGLE DRAWER

600

750

900

1200

PRODUCT CODE

4STA060S\_

4STA075S\_

4STA090S\_

4STA120S\_

Wall Hung



### DRAWER OPEN

600

NEW

750

NEW

900

NEW

1200

NEW

PRODUCT CODE

4STA060DO\_

4STA075DO\_

4STA090DO\_

4STA120DO\_

Wall Hung

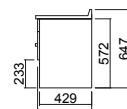
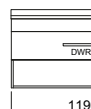
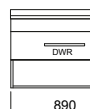
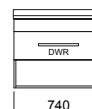

### DOUBLE DRAWER

600

750

900

1200

PRODUCT CODE

4STA060D\_

4STA075D\_

4STA090D\_

4STA120D\_

Wall Hung

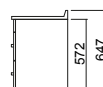

Floor Standing

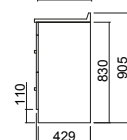
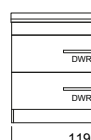
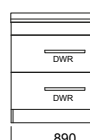
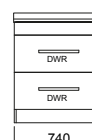
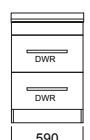

Drawer capacity rated to 9kg maximum load per drawer

**WHEN ORDERING:** Complete your chosen product code above by specifying one of the below cabinet finishes in the blank space at the end of the code \_  
Use **M** for White Melamine; **G** for White Gloss; **C** for Colour

# CASHMERE

## CLASSIC

- Vitreous china top with integrated overflow\*
- Single tap hole only
- Classic doors and drawers cabinet or NEW open style
- Floor Standing and Wall Hung options
- Soft closing doors and drawers
- Available in all cabinet finishes
- See pages 48-49 for additional information
- See pages 44-45 for mirrors and towers

Cabinets made in New Zealand

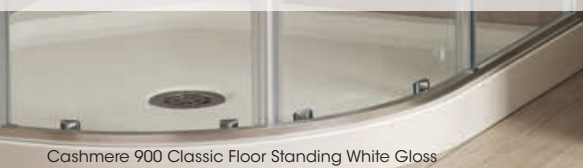

Cashmere 900 Classic Floor Standing White Gloss



Cashmere 750 Classic Wall Hung White Gloss



Cashmere 1200 Classic Floor Standing Manor Oak

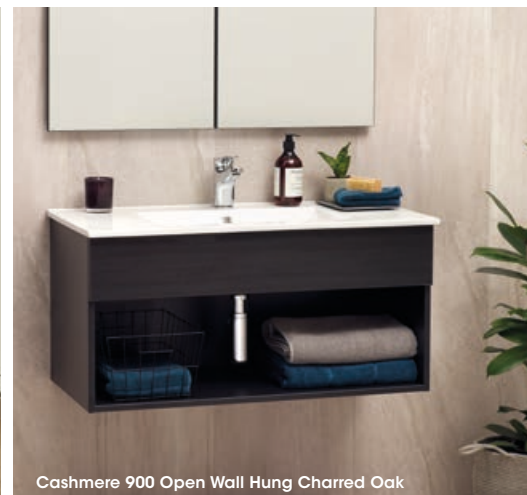

Cashmere 900 Open Wall Hung Charred Oak

Refer to clearlite.co.nz for full specifications

During manufacture of vitreous china there is shrinkage that is difficult to control, therefore measurements will always be variable.

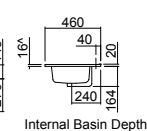
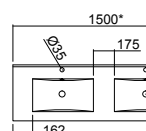
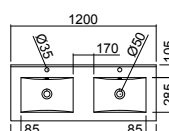
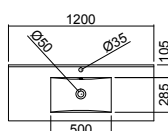
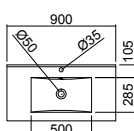
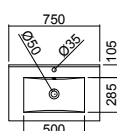
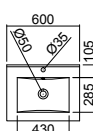

Internal Basin Depth  
135 mm

^ 22mm on 1500mm Double bowl

**OPEN** **600** **NEW** **750** **NEW** **900** **NEW** **1200** **NEW** **1200 DB** **NEW** **1500 DB**

PRODUCT CODE 4CAS0600\_ 4CAS0750\_ 4CAS0900\_ 4CAS1200\_ 4CAS12DO\_ 4CAS1500\_

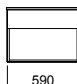
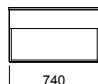
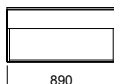
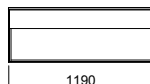
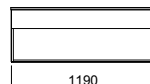
**Wall Hung**      N/A

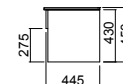

**DOORS & DRAWERS** **600** **750** **900** **1200** **1200 DB** **1500 DB**

PRODUCT CODE 4CAS060C\_ 4CAS075C\_ 4CAS090C\_ 4CAS120C\_ 4CAS12DC\_ 4CAS15DC\_

**Wall Hung**      

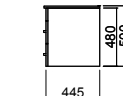

**Floor Standing**      

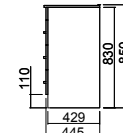

Drawer capacity rated to 9kg maximum load per drawer \*1500 size is a composite top

**WHEN ORDERING:** Complete your chosen product code above by specifying one of the below cabinet finishes in the blank space at the end of the code \_  
Use **M** for White Melamine; **G** for White Gloss; **C** for Colour



# CASHMERE

## DRAWER

- Vitreous china top with integrated overflow\*
- Single tap hole only
- Contemporary drawer only and NEW drawer open cabinet style
- Floor Standing and Wall Hung options
- Soft closing drawers
- Available in all cabinet finishes
- See pages 48-49 for additional information
- See pages 44-45 for mirrors and towers

Cabinets made in New Zealand

Cashmere 1200 Drawer Open White Gloss



Cashmere 1200 Double Drawer Floor Standing Basalt



Cashmere 1200 DB Double Drawer Wall Hung Dark Oak



Cashmere 900 Single Drawer Silva Strata

White Melamine

White Gloss

Dark Oak

Charred Oak

Silva Strata

Basalt

Nordic Ash

Manor Oak

Carbon

Refer to clearlite.co.nz for full specifications  
See left hand page for vanity top details

See page 48 for larger colour swatches

### SINGLE DRAWER

600

750

900

1200

1200 DB

1500 DB

PRODUCT CODE

4CAS060S\_

4CAS075S\_

4CAS090S\_

4CAS120S\_

4CAS12DS\_

4CAS15DS\_

Wall Hung

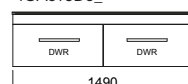
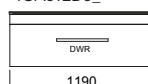
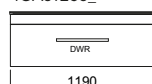
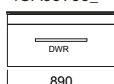
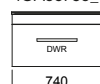

### DRAWER OPEN

600

NEW

750

NEW

900

NEW

1200

NEW

1200 DB

NEW

PRODUCT CODE

4CAS060DO\_

4CAS075DO\_

4CAS090DO\_

4CAS120DO\_

4CAS12DDO\_

N/A

Wall Hung

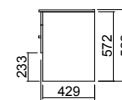
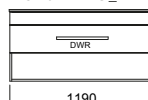
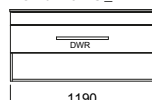
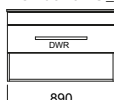
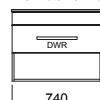
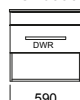

### DOUBLE DRAWER

600

750

900

1200

1200 DB

1500 DB

PRODUCT CODE

4CAS060D\_

4CAS075D\_

4CAS090D\_

4CAS120D\_

4CAS12DD\_

4CAS15DD\_

Wall Hung

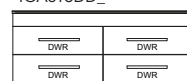
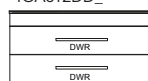
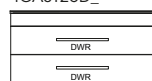
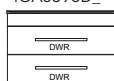
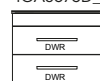

Floor Standing

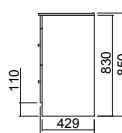
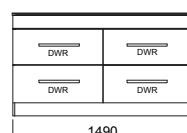
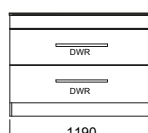
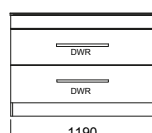
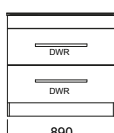
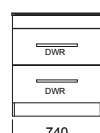
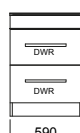

Drawer capacity rated to 9kg maximum load per drawer \*1500 size is a composite top

**WHEN ORDERING:** Complete your chosen product code above by specifying one of the below cabinet finishes in the blank space at the end of the code \_  
Use **M** for White Melamine; **G** for White Gloss; **C** for Colour

# CASHMERE SLIM

## CLASSIC

- Narrow design for smaller spaces
- Vitreous china top with integrated overflow
- Single tap hole only
- Classic doors and drawers and NEW open cabinet style
- Floor Standing and Wall Hung options
- Soft closing doors and drawers
- Available in all cabinet finishes
- See pages 48-49 for additional information
- See pages 44-45 for mirrors and towers

Cabinets made in New Zealand



Cashmere Slim 750 Classic Floor Standing Dark Oak

White Melamine	White Gloss	Dark Oak	Charred Oak	Silva Strata	Basalt	Nordic Ash	Manor Oak	Carbon
----------------	-------------	----------	-------------	--------------	--------	------------	-----------	--------

See page 48 for larger colour swatches



Cashmere Slim 600 Classic Wall Hung Charred Oak

Drawer capacity rated to 9kg maximum load per drawer

**WHEN ORDERING:** Complete your chosen product code above by specifying one of the below cabinet finishes in the blank space at the end of the code \_  
Use **M** for White Melamine; **G** for White Gloss; **C** for Colour

During manufacture of vitreous china there is shrinkage that is difficult to control, therefore measurements will always be variable.

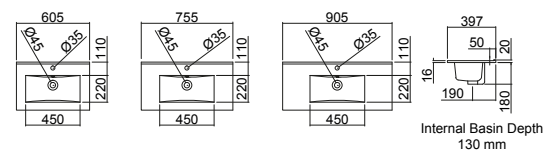

OPEN	600	NEW	750	NEW	900	NEW
PRODUCT CODE	4CSL060O_		4CSL075O_		4CSL090O_	

### Wall Hung

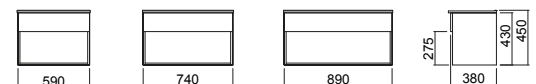

### DOORS & DRAWERS

	600	750	900
PRODUCT CODE	4CSL060C_	4CSL075C_	4CSL090C_

### Wall Hung



### Floor Standing

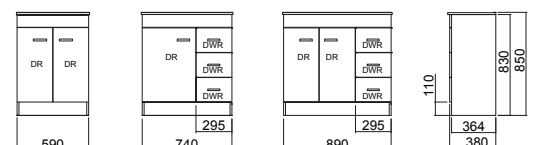

# CASHMERE SLIM

## DRAWER





- Narrow design for smaller spaces
- Vitreous china top with integrated overflow
- Single tap hole only
- Contemporary drawer only and NEW drawer open cabinet style
- Floor Standing and Wall Hung options
- Soft closing drawers
- Available in all cabinet finishes
- See pages 48-49 for additional information
- See pages 44-45 for mirrors and towers

Cabinets made in New Zealand

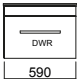
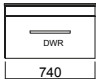
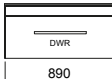
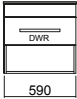
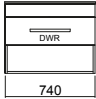
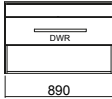

Cashmere Slim 900 Double Drawer Wall Hung Silva Strata

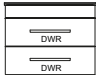
Refer to [clearlite.co.nz](http://clearlite.co.nz) for full specifications  
See left hand page for vanity top details

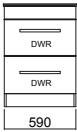
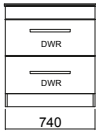
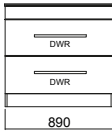
SINGLE DRAWER	600	750	900
PRODUCT CODE	4CSL060S_	4CSL075S_	4CSL090S_
Wall Hung			
DRAWER OPEN	600 NEW	750 NEW	900 NEW
PRODUCT CODE	4CSL060DO_	4CSL075DO_	4CSL090DO_
Wall Hung			
DOUBLE DRAWER	600	750	900
PRODUCT CODE	4CSL060D_	4CSL075D_	4CSL090D_
Wall Hung			
Floor Standing			

Drawer capacity rated to 9kg maximum load per drawer

**WHEN ORDERING:** Complete your chosen product code above by specifying one of the below cabinet finishes in the blank space at the end of the code \_  
Use **M** for White Melamine; **G** for White Gloss; **C** for Colour



Cashmere Slim 750 Double Drawer Floor Standing White Gloss



# PINNACLE

- Vitreous china top with integrated overflow\*
- Single tap hole only
- Contemporary drawer only cabinet style
- Floor Standing and Wall Hung options
- Soft closing drawers
- Available in all cabinet finishes
- See pages 48-49 for additional information
- See pages 44-45 for mirrors and towers

## Cabinets made in New Zealand



Pinnacle 900 Double Drawer Wall Hung Carbon



Pinnacle 750 Double Drawer Floor Standing Nordic Ash



Pinnacle 1200 Single Drawer Wall Hung Manor Oak

Refer to [clearlite.co.nz](http://clearlite.co.nz) for full specifications

During manufacture of vitreous china there is shrinkage that is difficult to control, therefore measurements will always be variable.

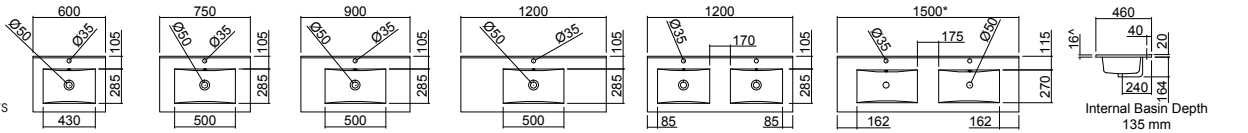

SINGLE DRAWER		600	750	900	1200	1200 DB	1500 DB	22mm on 1500mm Double bowl	
PRODUCT CODE		4PIN060S_	4PIN075S_	4PIN090S_	4PIN120S_	4PIN12DS_	4PIN15DS_		
Wall Hung									
DOUBLE DRAWER		600	750	900	1200	1200 DB	1500 DB		
PRODUCT CODE		4PIN060D_	4PIN075D_	4PIN090D_	4PIN120D_	4PIN12DD_	4PSL15DD_		
Wall Hung									
Floor Standing									

Drawer capacity rated to 9kg maximum load per drawer \*1500 size is a composite top

**WHEN ORDERING:** Complete your chosen product code above by specifying one of the below cabinet finishes in the blank space at the end of the code \_  
Use **M** for White Melamine; **G** for White Gloss; **C** for Colour

**NEW**

# PINNACLE SLIM

- Narrow design for smaller spaces
- Vitreous china top with integrated overflow
- Single tap hole only
- Contemporary drawer only cabinet style
- Floor Standing and Wall Hung options
- Soft closing drawers
- Available in all cabinet finishes
- See pages 48-49 for additional information
- See pages 44-45 for mirrors and towers

Cabinets made in New Zealand

Pinnacle Slim 900 Double Drawer Floor Standing Nordic Ash

White Melamine

White Gloss

Dark Oak

Charred Oak

Silva Strata

Basalt

Nordic Ash

Manor Oak

Carbon

See page 48 for larger colour swatches  
Refer to clearlife.co.nz for full specifications

During manufacture of vitreous china there is shrinkage that is difficult to control, therefore measurements will always be variable.

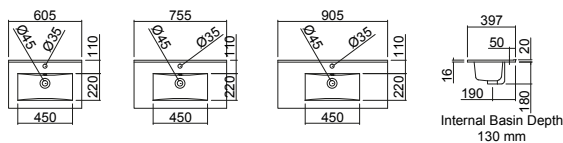

## SINGLE DRAWER

**600** **750** **900**

PRODUCT CODE 4PSL060S\_ 4PSL075S\_ 4PSL090S\_

### Wall Hung

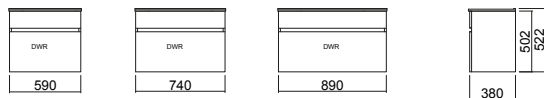

## DOUBLE DRAWER

**600** **750** **900**

PRODUCT CODE 4PSL060D\_ 4PSL075D\_ 4PSL090D\_

### Wall Hung

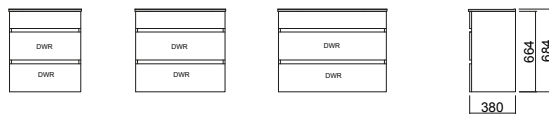

### Floor Standing

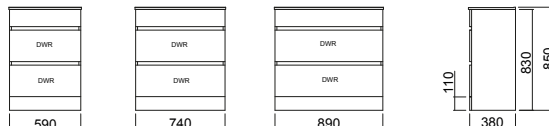

Drawer capacity rated to 9kg maximum load per drawer

**WHEN ORDERING:** Complete your chosen product code above by specifying one of the below cabinet finishes in the blank space at the end of the code \_  
Use **M** for White Melamine; **G** for White Gloss; **C** for Colour



Pinnacle Slim 600 Single Drawer Basalt

# RAGLAN

## CLASSIC

- Semi recess composite top with integrated overflow
- Generous basin size
- Single tap hole only
- Classic doors and drawers cabinet style
- Floor Standing and Wall Hung options
- Soft closing doors and drawers
- Available in all cabinet finishes
- See pages 48-49 for additional information
- See pages 44-45 for mirrors and towers

Cabinets made in New Zealand



Raglan 750 Classic Wall Hung Manor Oak

Refer to [clearlite.co.nz](http://clearlite.co.nz) for full specifications

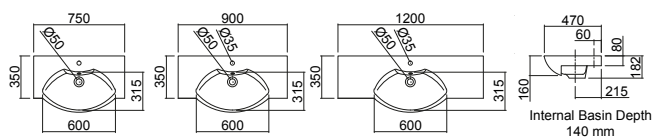

### DOORS AND DRAWERS

PRODUCT CODE

Wall Hung

Floor Standing

	750	900	1200	
PRODUCT CODE	4RAG075C_	4RAG090C_	4RAG120C_	
Wall Hung				
Floor Standing				



Raglan 900 Classic Floor Standing Carbon

Drawer capacity rated to 9kg maximum load per drawer

**WHEN ORDERING:** Complete your chosen product code above by specifying one of the below cabinet finishes in the blank space at the end of the code \_  
Use **M** for White Melamine; **G** for White Gloss; **C** for Colour



# RAGLAN

## DRAWER

- Semi recess composite top with integrated overflow
- Generous basin size
- Single tap hole only
- Contemporary drawer only cabinet style
- Floor Standing and Wall Hung options
- Soft closing doors and drawers
- Available in all cabinet finishes
- See pages 48-49 for additional information
- See pages 44-45 for mirrors and towers

Cabinets made in New Zealand



Raglan 1200 Double Drawer Floor Standing Basalt

White Melamine

White Gloss

Dark Oak

Charred Oak

Silva Strata

Basalt

Nordic Ash

Manor Oak

Carbon

See page 48 for larger colour swatches  
Refer to [clearlite.co.nz](http://clearlite.co.nz) for full specifications  
See left hand page for vanity top details

### SINGLE DRAWER

750

900

1200

PRODUCT CODE

4RAG075S\_

4RAG090S\_

4RAG120S\_

### Wall Hung

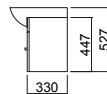
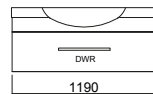
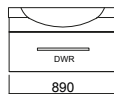

### DOUBLE DRAWER

750

900

1200

PRODUCT CODE

4RAG075D\_

4RAG090D\_

4RAG120D\_

### Wall Hung

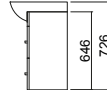
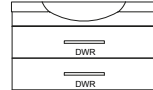

### Floor Standing

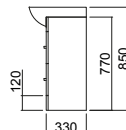
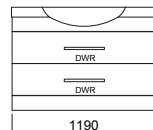
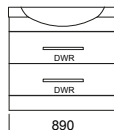
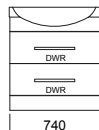

Drawer capacity rated to 9kg maximum load per drawer

**WHEN ORDERING:** Complete your chosen product code above by specifying one of the below cabinet finishes in the blank space at the end of the code \_  
Use **M** for White Melamine; **G** for White Gloss; **C** for Colour



Raglan 750 Single Drawer White Gloss

# SUMNER

- Semi recessed 75mm thick composite top
- Single tap hole only
- Classic doors and drawers or contemporary drawer only cabinet styles
- Floor Standing and Wall Hung options
- Not available in White Melamine
- See pages 48-49 for additional information
- See pages 44-45 for mirrors and towers

Cabinets made in New Zealand



Sumner 1200 Single Drawer Dark Oak



Sumner 1400 DB Classic Wall Hung Basalt



Sumner 900 Classic Floor Standing White Gloss

White Gloss

Dark Oak

Charred Oak

Silva Strata

Basalt

Nordic Ash

Manor Oak

Carbon

Refer to [clearlite.co.nz](http://clearlite.co.nz) for full specifications

See page 48 for larger colour swatches

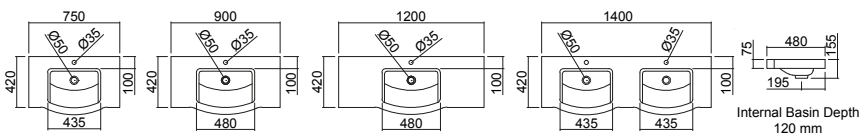

	750	900	1200	1400 DB
<b>SINGLE DRAWER</b>				
PRODUCT CODE	4SUM075S_	4SUM090S_	4SUM120S_	4SUM14DS_
<b>Wall Hung</b>				
	740	890	1190	1390
<b>DOORS AND DRAWERS</b>				
PRODUCT CODE	4SUM075C_	4SUM090C_	4SUM120C_	4SUM14DC_
<b>Wall Hung</b>				
<b>Floor Standing</b>				
	234 740 234	285 890 285	285 1190 285	285 1390 285

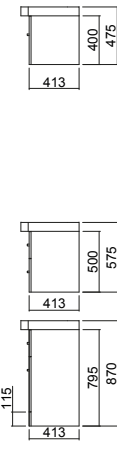

Drawer capacity rated to 9kg maximum load per drawer

**WHEN ORDERING:** Complete your chosen product code above by specifying one of the below cabinet finishes in the blank space at the end of the code \_  
Use **G** for White Gloss; **C** for Colour



Grafton 1400 DB Double Drawer Wall Hung Charred Oak & Mirrored Tower



Grafton 900 Double Drawer Floor Standing Nordic Ash



Grafton 900 Single Drawer White Gloss

# GRAFTON

- Semi recessed 75mm thick composite top
- Single tap hole only
- Contemporary drawer only cabinet style with concealed opening
- Floor Standing and Wall Hung options
- Soft Closing Drawers
- Not available in White Melamine
- See pages 48-49 for additional information
- See pages 44-45 for mirrors and towers

Cabinets made in New Zealand



Refer to [clearlite.co.nz](http://clearlite.co.nz) for full specifications

See page 48 for larger colour swatches

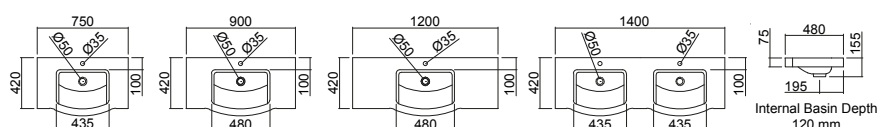

## SINGLE DRAWER

PRODUCT CODE

Wall Hung

750	900	1200	1400 DB
4GRA075S_	4GRA090S_	4GRA120S_	4GRA14DS_
740	890	1190	1390

413	475	550
-----	-----	-----

## DOUBLE DRAWER

PRODUCT CODE

Wall Hung

750	900	1200	1400 DB
4GRA075D_	4GRA090D_	4GRA120D_	4GRA14DD_
740	890	1190	1390

413	605	680
-----	-----	-----

Floor Standing

750	900	1200	1400 DB
740	890	1190	1390

120	795	870
413		

Drawer capacity rated to 9kg maximum load per drawer

**WHEN ORDERING:** Complete your chosen product code above by specifying one of the below cabinet finishes in the blank space at the end of the code \_  
Use **G** for White Gloss; **C** for Colour



# MIRRORS & MIRROR CABINETS

## MIRRORS

- Flat mirrors with 2 edge designs to choose from
- Can be hung either way
- 2 year warranty
- Includes mounting brackets
- Available in 6 sizes

### POLISHED EDGE

600 X 400	7346030401
1000 X 500	7346030901
1000 X 600	7346030601
1000 X 750	7346030902
1000 X 900	7346030903
1000 X 1200	7346031201



1000x750 Polished Edge

### BEVELLED EDGE

600 X 400	7346010401
1000 X 500	7346010901
1000 X 600	7346010601
1000 X 750	7346010902
1000 X 900	7346010903
1000 X 1200	7346011201



1000x750 Bevelled Edge

Suitable for use with demisters



Bevelled Edge 1000 x 900 Mirror with 2 Door 350 Tower and Cashmere 900 Double Drawer Basalt

White Melamine	Dark Oak	Charred Oak	Silva Strata	Basalt	Nordic Ash	Manor Oak	Carbon
----------------	----------	-------------	--------------	--------	------------	-----------	--------

See page 48 for larger colour swatches

## MAHIA MIRROR CABINET

- Internal glass shelving for a discrete storage solution
- Can be recessed into the wall
- 1200 size features side wing mirrors hinged to give a full viewing perspective

Rotate to hinge door from the RHS	Rotate to hinge door from the RHS	
MIRROR DR	MIRROR DR	MIRROR DR MIRROR DR
2 adjustable glass shelves	2 adjustable glass shelves	2 adjustable glass shelves
<b>400 x 500</b> <b>NEW</b>	<b>450 x 800</b>	<b>600 x 800</b>
<b>MELAMINE</b>	4MAH040ZM 4MAH040ZC	4MAH060ZM 4MAH060ZC
Rotate to hinge door from the RHS	Rotate to hinge door from the RHS	Rotate to hinge door from the RHS
MIRROR DR MIRROR DR	MIRROR DR MIRROR DR	MIRROR DR MIRROR DR MIRROR DR
2 adjustable glass shelves	2 adjustable glass shelves	6 adjustable glass shelves
<b>750 x 800</b>	<b>900 x 800</b>	<b>1200 x 800</b>
<b>MELAMINE</b>	4MAH075ZM 4MAH075ZC	4MAH120ZM 4MAH120ZC



Mahia 900 x 800 Mirror Cabinet with Cashmere 900 Open Wall Hung Charred Oak

# TOWERS



Classic 350 Tower White Gloss



Two Door 250 Tower Charred Oak



Grafton 350 Tower Silva Strata

## CLASSIC

- Available in all Clearlite colours
- Left or right hand hinged
- Select handle style to complement vanity - see options below

Made in New Zealand

## TWO DOOR

- Standard or Slimline styles
- Available in all Clearlite colours
- Left or right hand hinged
- Select handle style to complement vanity - see options below

Made in New Zealand

## GRAFTON

- Concealed opening system
- Soft closing doors
- Mirrored door upgrade available
- Available in all Clearlite colours
- Left or right hand door opening
- Complements Grafton and Pinnacle vanities

Made in New Zealand

300	350	250	300	350
4TCLS030Z_	4TCLS035Z_	4TDR025Z_	4TDR030Z_	4TDR035Z_
<div> <div>1600</div> <div>430</div> <div>220</div> <div>320</div> <div>300</div> <div>SOLID DR</div> <div>DWR</div> <div>DWR</div> </div>	<div> <div>1600</div> <div>430</div> <div>220</div> <div>380</div> <div>350</div> <div>SOLID DR</div> <div>DWR</div> <div>DWR</div> </div>	<div> <div>1600</div> <div>250</div> <div>250</div> <div>250</div> <div>250</div> <div>SOLID DR</div> <div>620</div> <div>SOLID DR</div> <div>620</div> </div>	<div> <div>1600</div> <div>320</div> <div>300</div> <div>320</div> <div>300</div> <div>SOLID DR</div> <div>620</div> <div>SOLID DR</div> <div>620</div> </div>	<div> <div>1600</div> <div>380</div> <div>350</div> <div>380</div> <div>350</div> <div>SOLID DR</div> <div>620</div> <div>SOLID DR</div> <div>620</div> </div>
2 adjustable solid shelves		2 adjustable solid shelves		

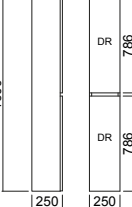
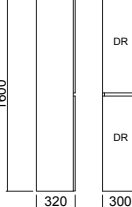
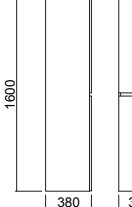
	250	300	350
Doors	4TGRD025Z_	4TGRD030Z_	4TGRD035Z_
Mirrored Doors	4TGRM025Z_	4TGRM030Z_	4TGRM035Z_
			
	4 Internal Glass Shelves	4 Internal Glass Shelves	4 Internal Glass Shelves

White Melamine	White Gloss	Dark Oak	Charred Oak	Silva Strata	Basalt	Nordic Ash	Manor Oak	Carbon
----------------	-------------	----------	-------------	--------------	--------	------------	-----------	--------

See page 48 for larger colour swatches

Handle to suit  
Statesman and  
Hand Basins



Handle to suit  
Cashmere, Raglan  
and Sumner



**WHEN ORDERING:** Complete your chosen product code above by specifying one of the below cabinet finishes in the blank space at the end of the code \_  
Use **M** for White Melamine; **G** for White Gloss; **C** for Colour

# HAND BASINS

## WB22

- Slimline cabinet and acrylic top
- Top can be purchased separately
- Floor standing or wall hung
- Soft closing doors
- Available in all Clearlite colours

Made in New Zealand

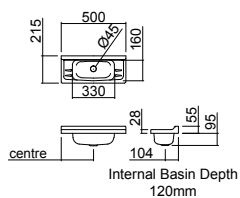

500

4WB2050Z\_

### Wall Hung



### Floor Standing

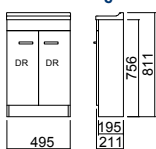

WB22 Floor Standing White Gloss

## MADRID

- Semi recessed vitreous china basin with integrated overflow
- Taphole right hand side only
- Floor standing or wall hung
- Left or right hand hinged

Cabinet made in New Zealand

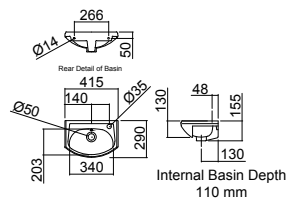

415

4MAD040Z\_

### Wall Hung



### Floor Standing

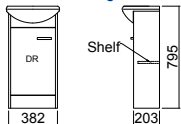

Madrid Wall Hung Manor Oak



Madrid Floor Standing White Gloss

**WHEN ORDERING:** Complete your chosen product code above by specifying one of the below cabinet finishes in the blank space at the end of the code \_  
Use **M** for White Melamine; **G** for White Gloss; **C** for Colour



See page 48 for larger colour swatches



Mimas 500 Floor Standing Nordic Ash



Mimas 400 Wall Hung Dark Oak



Mimas 400 Floor Standing Manor Oak

## MIMAS

- Compact composite basin in two sizes
- Reversible tap positions
- Floor standing or wall hung
- Soft closing door/s
- Available in all Clearlite colours

### Cabinet made in New Zealand

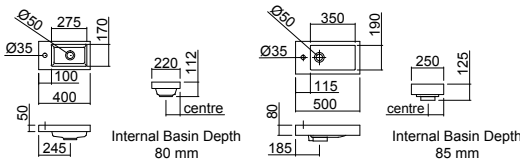

**400**

4MIM040Z\_

**500**

4MIM050Z\_

#### Wall Hung

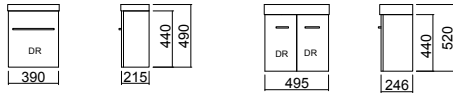

#### Floor Standing

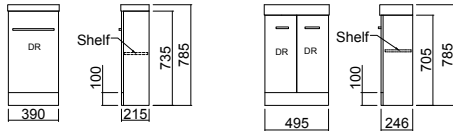

Veva 500 Floor Standing Nordic Ash



Veva 400 Wall Hung Basalt



Veva 400 Floor Standing White Gloss

## VEVA

- Compact composite basin in two sizes
- Reversible tap positions
- Available Floor Standing or Wall Hung
- Soft closing door/s

### Cabinet made in New Zealand

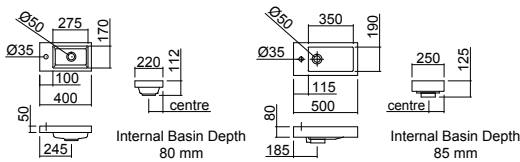

**400**

4VEV040Z\_

**500**

4VEV050Z\_

#### Wall Hung

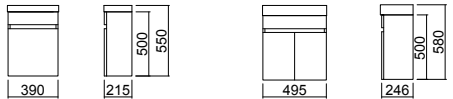

#### Floor Standing

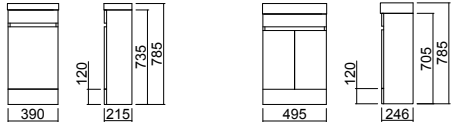

**WHEN ORDERING:** Complete your chosen product code above by specifying one of the below cabinet finishes in the blank space at the end of the code \_  
Use **M** for White Melamine; **G** for White Gloss; **C** for Colour

# CABINET FINISHES & VANITY TOPS

Clearlite cabinet finishes are extremely high quality. Compared to wood veneer, and paint, they will resist bumps and knocks more readily and are more likely to maintain their as new finish over time as paints and lacquers tend to dull with ongoing exposure to UV.

**WHITE GLOSS** - A White Gloss cabinet delivers a timeless style. Gloss vinyl (PVC) is vacuum-formed and pressed over the cabinets surface to create a seamless vanity that is long lasting with a chip resistant surface.

**WHITE MELAMINE** - Clearlite white melamine cabinets with PVC capped edges offer affordable quality.

**COLOUR FINISHES** - A coloured cabinet is the perfect way to bring personality and depth to the bathroom. The coloured layer is heat bonded in to the surface of NZ board and is finished with PVC capped edges. The result is a hard wearing durable cabinet that when looked after, will look like new for years to come.

NOTE: Colour reproduction is as near to actual colour as printing methods allow.



## VANITY TOPS

**VITREOUS CHINA** (or VC) has a classic appearance with its solid glassy finish. VC products offer excellent heat, scratch, stain and wear resistance. Made from a natural material it is a cast ceramic (clay) glazed with enamel (glass). Due to the nature of its production, visible imperfections are part of the overall look of VC meaning no two tops are produced the same.

**COMPOSITE** tops and basins have a gloss surface that achieves a clean smooth look almost free from surface imperfections. Tops are resistant to impact damage and offer good dimensional stability. Composite tops are created using a mixture of resin and mineral fillers with a hardwearing gel coat top surface.

**ACRYLIC** vanity tops offer a glossy smooth finish with straight edges. A hardwearing product that is manufactured using thermoformed Lucite® acrylic reinforced with polyester resin.

## DESIGN PARTNERS

Clearlite would like to acknowledge the support of the following businesses who helped with the creation of many bathroom sets within this catalogue.



METHVEN



## FUTURE PROOF BUILDING

Future Proof Building is a national initiative involving leading brands and service providers in the building industry. Simply put, it means choosing features and solutions for your home that best suit to improve the quality of life for your family. This can contribute towards minimising your home maintenance and improving your home's future value. For Clearlite, it's about supplying you with quality products, reducing product life cycle costing, ensuring health and safety features, creating options for space management and being aware of our environmental/resource responsibilities. [fpb.co.nz](http://fpb.co.nz)



# VANITY CABINET MATERIALS



## MATERIAL AND CONSTRUCTION

The foundation of great design is top class materials and construction. At Clearlite Bathrooms we are proud to know that our customers enjoy world class materials in the construction of all cabinets, which are manufactured right here in New Zealand. If you visit the leading interior fashion fairs in Milan or Cologne, you will see New Zealand can manufacture to a standard that is the equal of anywhere in the world, if not better. The key materials in our vanity cabinets utilise the best in worldwide proven market-leading technology.



## BOARD + BOND = THE MOISTURE RESISTANT TEAM

Bathrooms by their nature are exposed to moisture from splashes and steam. For all melamine and colour finishes we use New Zealand supplied Moisture Resistant Board. It is the combination of this Moisture Resistant board with PUR bonding technology that delivers the most moisture, and heat resistant cabinet possible. PUR bonding technology was originally developed in Europe to withstand the harsh shipping conditions to the fast-growing, demanding luxury markets of the Middle East. PUR bonding is acknowledged worldwide as delivering the most heat resistant, moisture resistant, and near-seamless bond possible. Technically it chemically sets against the moisture carried via air and therefore it literally resists moisture. For this reason it is the perfect pairing with the Moisture Resistant board.



## NEW ZEALAND GROWN - NEW ZEALAND MANUFACTURED - ENVIRONMENTALLY SUSTAINABLE BOARD.

New Zealand's board is highly regarded around the world for its environmental sustainability and low emission characteristics. Sourced only from New Zealand's sustainable FSC certified Radiata Pine Plantations, New Zealand board producers pioneered the drive to low-formaldehyde emissions. This quality standard is required in key export markets of Japan and USA and is delivered to our customers. This low emission board is infused with a treatment that provides the extra resistance to splashes and steam when compared to standard board.



## CLEANING AND MAINTENANCE

Extending the life and appearance of your Clearlite vanity is easy. Simply wipe down all water from the vanity surface and clean regularly using Vibrance Surface Cleaner. The Vibrance Surface Cleaner is suitable on acrylic, vitreous china, melamine and coloured finishes.

## WARRANTIES

At Clearlite Bathrooms we stand behind our products and offer warranties on all our bathroomware so that you have peace of mind that what you have purchased for your home is of the highest quality and fits the purpose it was intended for. All Clearlite products come with installation instructions which are also available on our website. We recommend you use a professional tradesman to install your product such as a trained shower installer. This ensures that warranty requirements are met during installation and to future proof your bathroom.

WARRANTIES*	COVERAGE
Showers, Baths, Vanities, Furniture	5 Years
Drip Strips & Vertical Seals	1 Year
Mirrors	2 Years
Spa (electronics, pump and fittings)	2 Years

**NOTE: Warranty is void if products are not installed according to our specifications.**  
**Please visit our website for installation instructions.**

Note: Some cleaners are not suitable for acrylic surfaces and if used may cause premature failure of the product that will not be covered under warranty. \*Special care should be taken when selecting a cleaner.\* Clearlite retains the right to change products and specifications without notice. Handle styles in particular can vary as new designs become available. This brochure does not constitute an offer by Clearlite and is not intended as an exhaustive description of product performance for suitability. All measurements are nominal. This brochure supercedes all previous brochures. This edition is dated March 2016. Tapware and accessories shown in this brochure are for photography purposes only.



# BATHROOM PLANNER

The Clearlite Bathroom Planner that follows is a great tool to help you layout and visualise your bathroom using Clearlite products.

Your Bathroom Planner should only be considered as a guide, always ensure you confirm details with your trade professional.

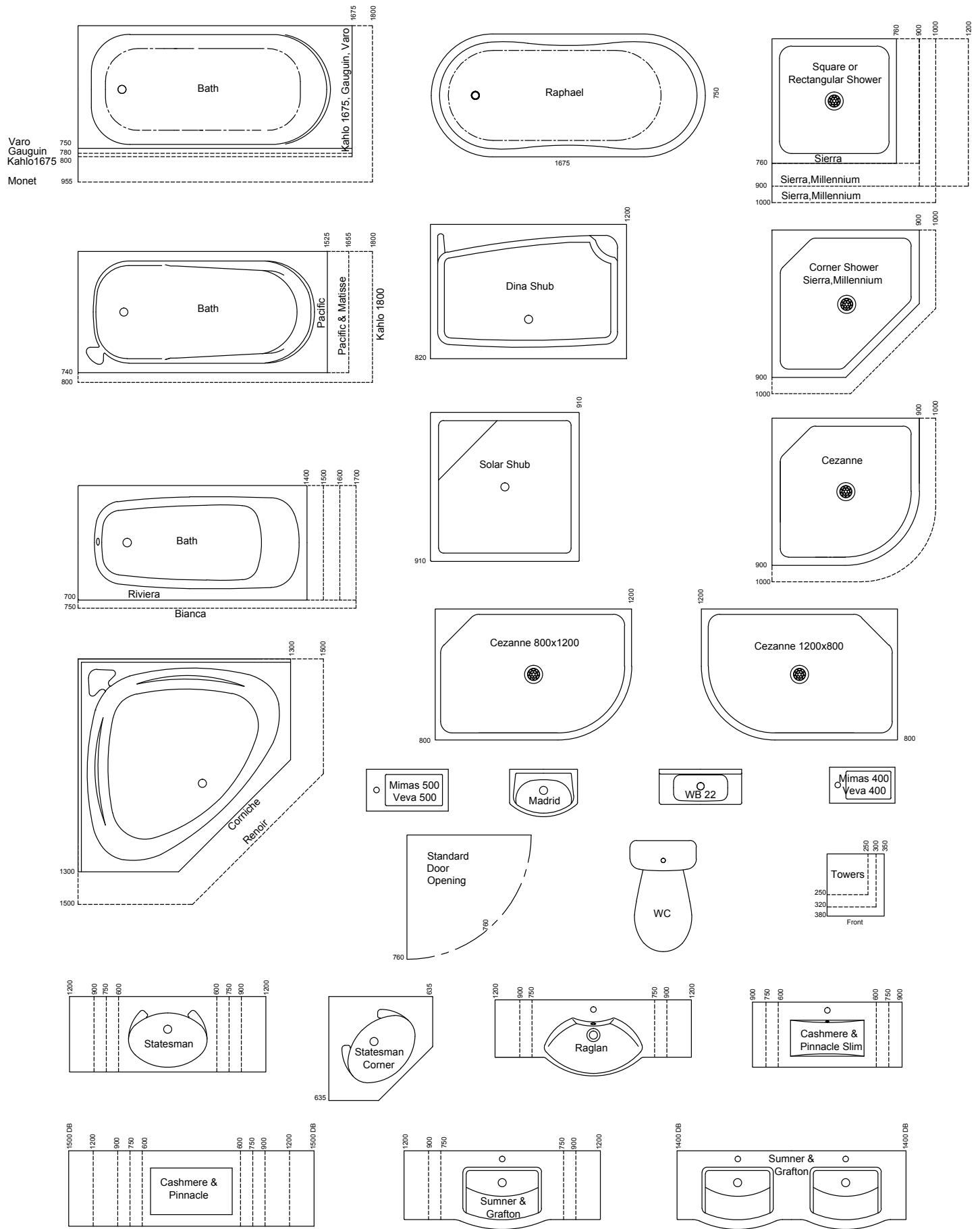

- 1 Start by measuring the size of your bathroom space. Draw these measurements on the bathroom grid, making sure you use the scale to get the correct size and shape. One square equals 100mm.
- 2 Mark in any window and door positions and note the way they open. It's also useful to measure the height to the window sills, which can help with your decision on product placement.
- 3 If you wish to keep any existing plumbing fittings (shower mixer, taps, inlet pipes, water pipes, and toilet waste pipes) or electrical fittings (electrical points, switches and heaters), make sure you mark these onto your grid.
- 4 Select which Clearlite products you would like in your new bathroom.
- 5 Once you have chosen your Clearlite products, cut out each diagram from the Bathroom planner. Make sure you cut out the correct lines for the length and width of your product. You might want to double check measurements in the Clearlite Catalogue prior to cutting.
- 6 Place all product diagrams on the Bathroom Planner and move them around until you find the combination that works best for you. Important factors to think about are:
  - Allowing enough room for doors and windows to open.
  - Products such as a toilet/bidet are best positioned away from the bathroom door opening.
  - It's better to place a product of interest in the direct line of vision upon entry.
  - Make sure the location of products are in the best area to be used.What would work best in your daily routine? Can family members or children use the product with ease?

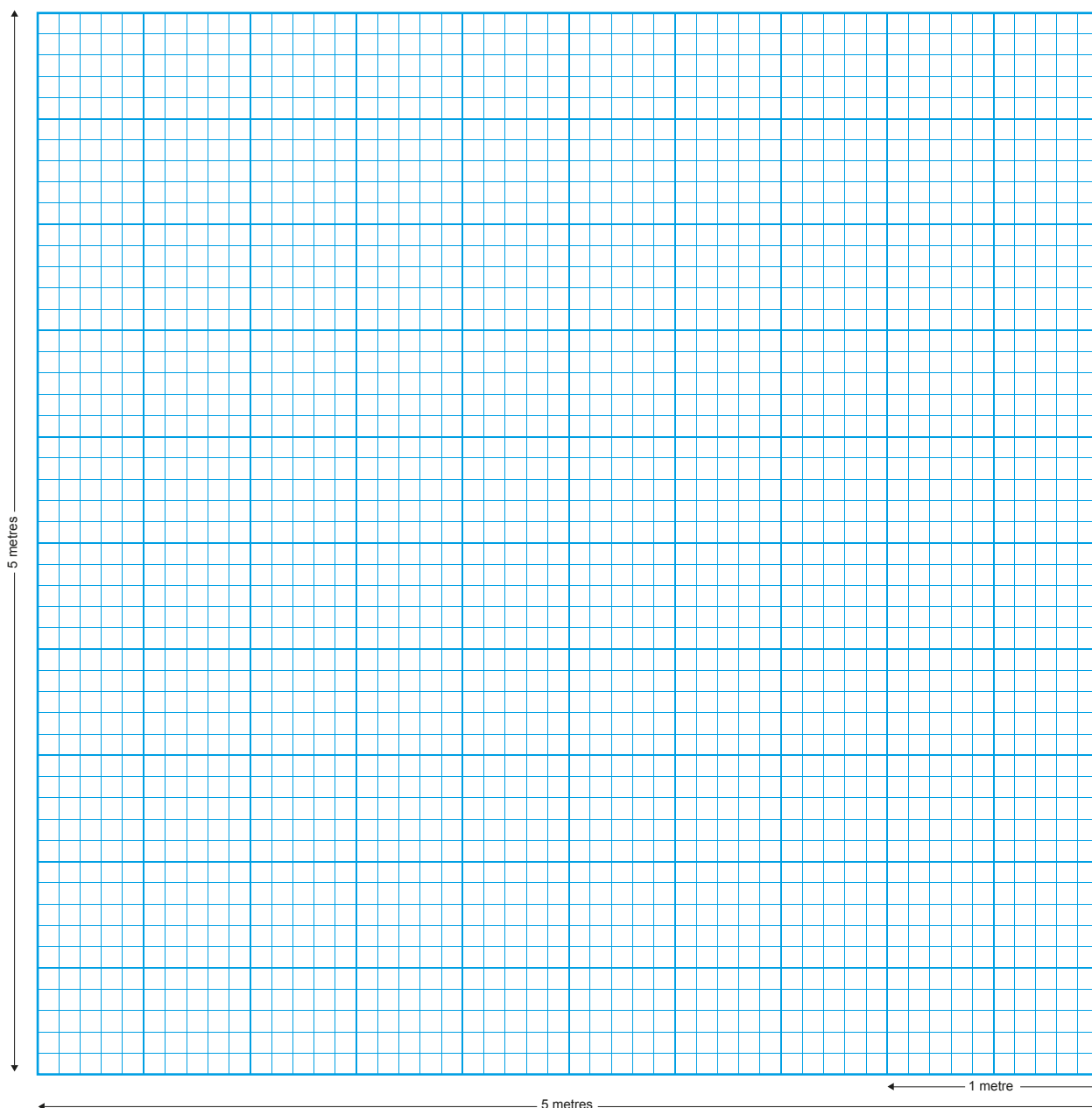

# WHERE TO VIEW

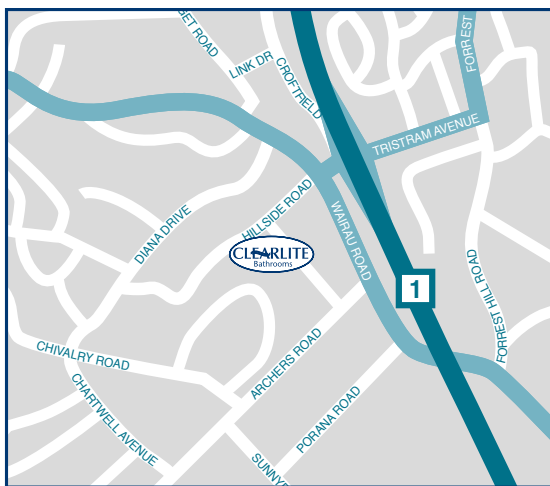

## CLEARLITE SHOWROOM

### CLEARLITE BATHROOMS AUCKLAND

54-58 Hillside Rd,  
Glenfield, Auckland 0627  
Private Bag 40902, Glenfield, Auckland 0747  
P (09) 444 3780  
F 0800 88 00 11  
E [info@clearlite.co.nz](mailto:info@clearlite.co.nz)

### OPENING HOURS

Monday - Friday 8.00am - 5.00pm  
Saturday 9am - 12pm  
Closed Sundays and public holiday weekends

Your local plumbing and building merchants also display selected products.  
Please contact the Clearlite customer services team to enquire about viewing specific products or for other product enquiries; 09 444 3780 / [info@clearlite.co.nz](mailto:info@clearlite.co.nz)



[clearlite.co.nz](http://clearlite.co.nz) 100% NEW ZEALAND OWNED AND OPERATED



See page 48 for more information